

START HERE!

READ ME FIRST

Don't be a hero and muscle through this installation without reading these fitting instructions first! Improper installation of this gear may void certain aspects of your warranty.

Before you begin, take a moment and open all your Front Runner rack kit boxes and gather the assembly instructions for the various components.

A complete kit will contain:

1. A Front Runner Mounting System specific to your vehicle
2. A Front Runner Rack Tray or Load Bar Slats

This document will guide you through the assembly of the mounting system and assist you in fitting the roof rack tray or load bars to your specific vehicle.

Please refer to the next page for a list of all the components, quantities and tools required.

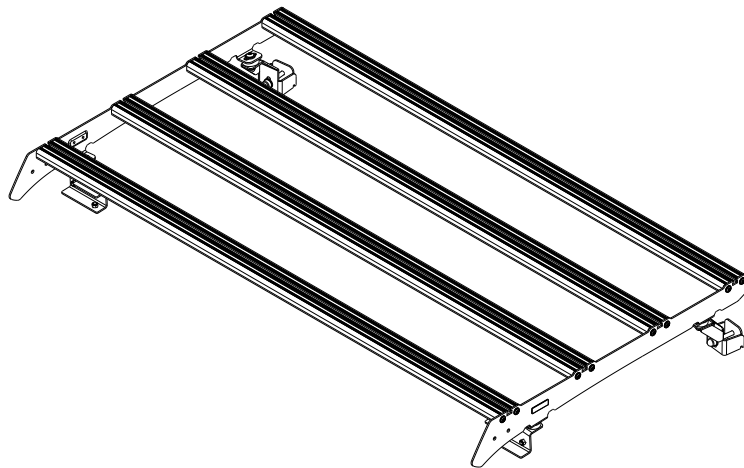

IMPORTANT WARNING! ⚠️

IT IS CRITICAL THAT ALL FRONT RUNNER PRODUCTS BE PROPERLY AND SECURELY ASSEMBLED AND ATTACHED TO YOUR VEHICLE. IMPROPER ATTACHMENT COULD RESULT IN AN AUTOMOBILE ACCIDENT, AND COULD CAUSE SERIOUS BODILY INJURY OR DEATH. YOU ARE RESPONSIBLE FOR ASSEMBLING AND SECURING ALL FRONT RUNNER PRODUCTS TO YOUR VEHICLE, CHECKING THE ATTACHMENTS PRIOR TO USE, AND PERIODICALLY INSPECTING THE PRODUCTS FOR ADJUSTMENT, WEAR AND DAMAGE. THEREFORE, YOU MUST READ AND UNDERSTAND ALL OF THE INSTRUCTIONS AND PRECAUTIONS SUPPLIED WITH YOUR FRONT RUNNER PRODUCT PRIOR TO INSTALLATION OR USE. IF YOU DO NOT UNDERSTAND ALL OF THE INSTRUCTIONS AND CAUTIONS, OR IF YOU HAVE NO MECHANICAL EXPERIENCE AND ARE NOT THOROUGHLY FAMILIAR WITH THE INSTALLATION PROCEDURES, YOU SHOULD HAVE THE PRODUCT INSTALLED BY A PROFESSIONAL INSTALLER OR OTHER QUALIFIED PERSONNEL.

NOTE: Front Runner will not be responsible for any damage caused by the failure to install the product according to these instructions.

Please call us if you have any questions about the installation of this product.



1 GET ORGANIZED

IN THE BOX

- | | | |
|----|------|------------------------------------|
| 1 | 1 X | Foot Rail LH |
| 2 | 1 X | Foot Rail RH |
| 3 | 4 X | Standard Slat |
| 4 | 1 X | Internal Mounting bracket Rear RH |
| 5 | 1 X | Internal Mounting bracket Rear LH |
| 6 | 1 X | Internal Mounting bracket Front LH |
| 7 | 1 X | Internal Mounting bracket Front RH |
| 8 | 16 X | M6 X 25 Thread Forming Screw |
| 9 | 2 X | Rear Clamping Plate |
| 10 | 6 X | M8 X 19 x 2SS Flat Washer |
| 11 | 2 X | M8 X 60 Hex Bolt |
| 12 | 6 X | M8 Nyloc Nut |
| 13 | 6 X | M8 Nut Cap |
| 14 | 4 X | M6 x 12 Button Head Screw |
| 15 | 4 X | M6 Nut Cap |
| 16 | 4 X | Spacer 19 X 12.58 X 12 |
| 17 | 4 X | Foam Rubber Seal |
| 18 | 4 X | M8 X 30 Button Head Screw |

TOOLS NEEDED

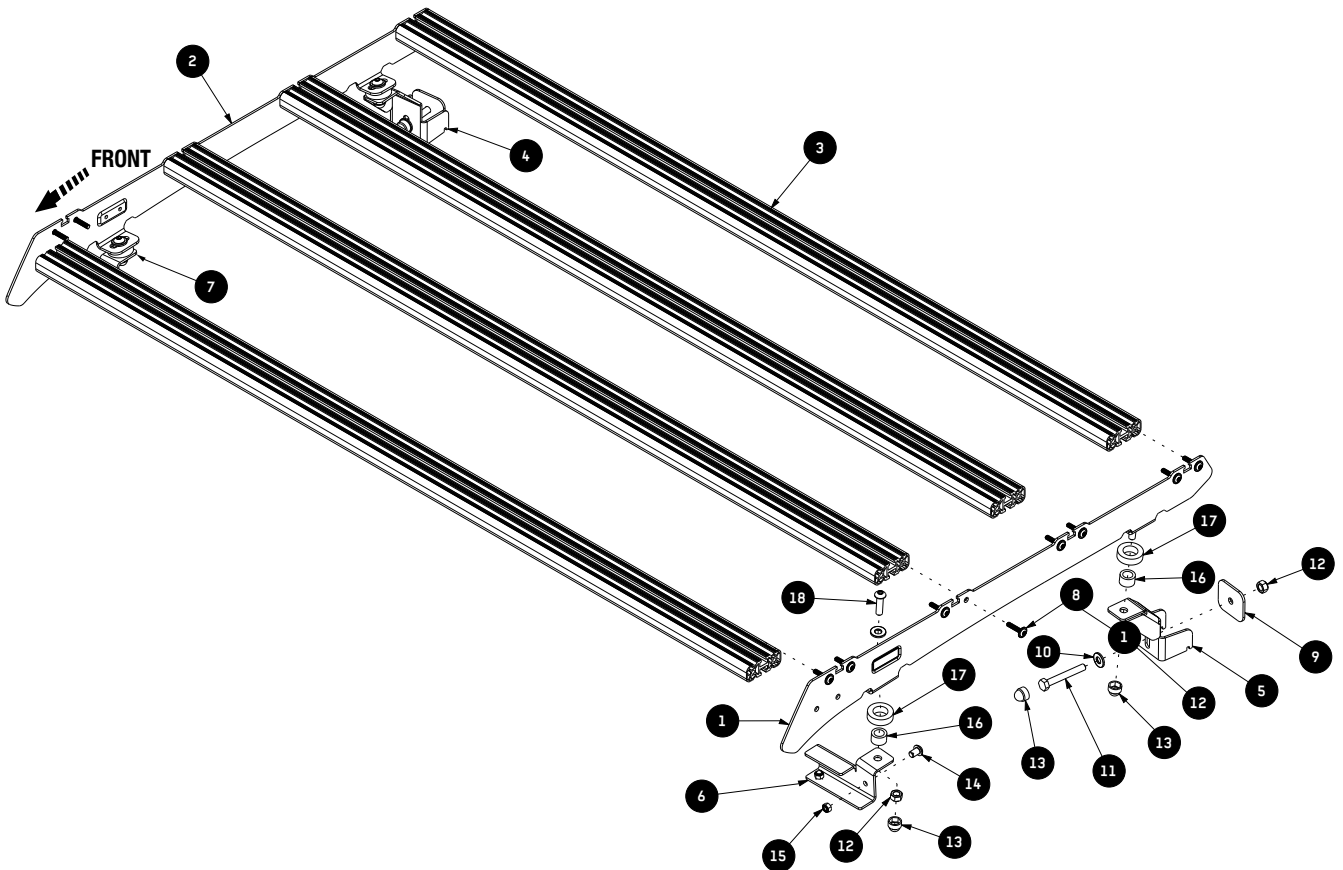
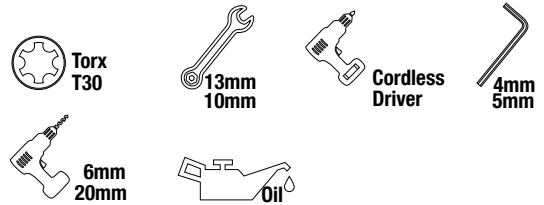

2 ASSEMBLY

2

2.1

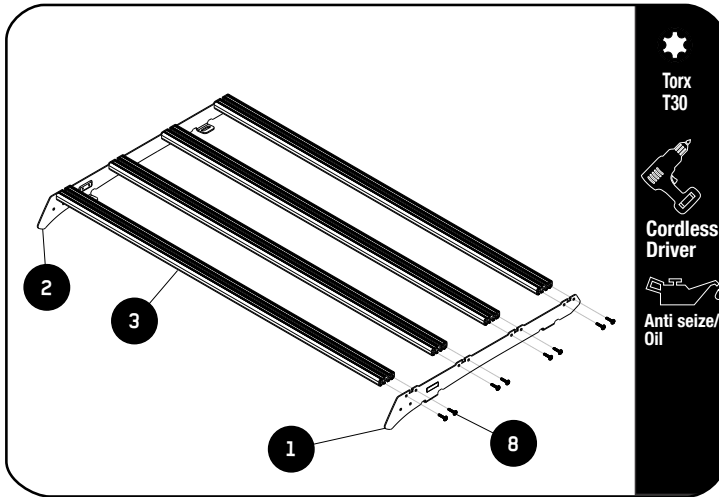

Fit 4 Slimsport Slats (Item 3) to the Foot Rails (Item 1 & 2) using 16 x M6 x 25 Thread Forming Screws (Item 8) as shown.

Apply a little Anti Seize / oil on screw threads before inserting. Note these are thread forming screws.

Tightening Torque 8-10Nm / 5.9 ft lb - 7.38 ft lb. Take care when using a cordless driver.

3 FIT AND SECURE

3.1



Start by removing the 4 bolts holding the roof in place to gain access behind the roof and keep aside to refit.

Look on Youtube for assistance.

3.2

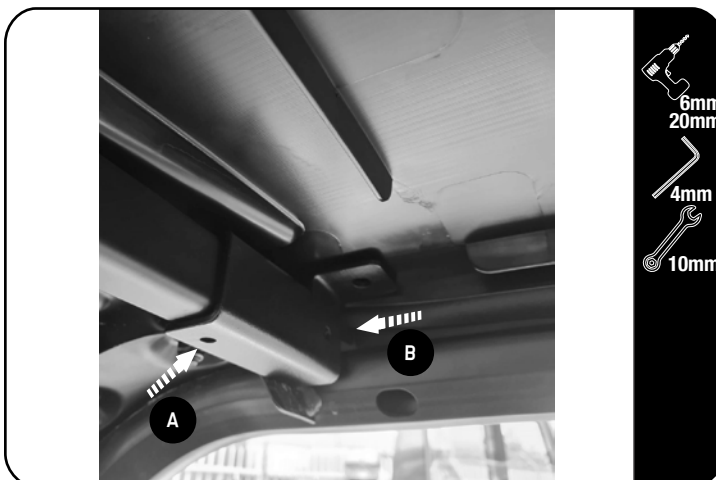

Place the Front Mounting Bracket (Item 6) onto the front Cross member and secure the Front mounting Bracket To the OEM hole (A) Using M6 x 12 Button Head Bolt and M6 Nyloc Nut (Item 14 & 15). Fully Tighten.

Drill the second hole (B) using a 6.5mm drill and secure using M6 x 12 Button Head Bolt and M6 Nyloc Nut (Item 14 & 15). Fully Tighten.

Tightening Torque:

M6 : 8-10Nm / 5.9 ft lb - 7.38 ft lb

2 FIT AND SECURE

2.1

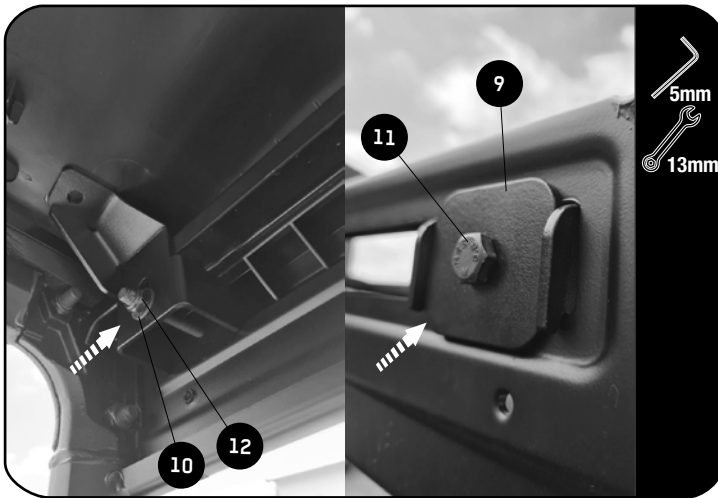

Place the Rear Mounting Bracket (Item 4 & 5) onto the rear Cross member and place the Rear Clamping Plate (Item 9) at the back of the crossmember as shown.

Secure the Rear mounting Bracket To the Cross member Using M8 x 30 Hex Bolt , M8x19x2 Flat Washer and M8 Nyloc Nut (Item 10,11&12) as shown.

Do this Both LH and RH side.

Move the Bracket all the way to the outer edge of the cross member and fully tighten.



Tightening Torque:

M8 : 15-20Nm / 11.06 ft lb - 14.75 ft lb

2.2

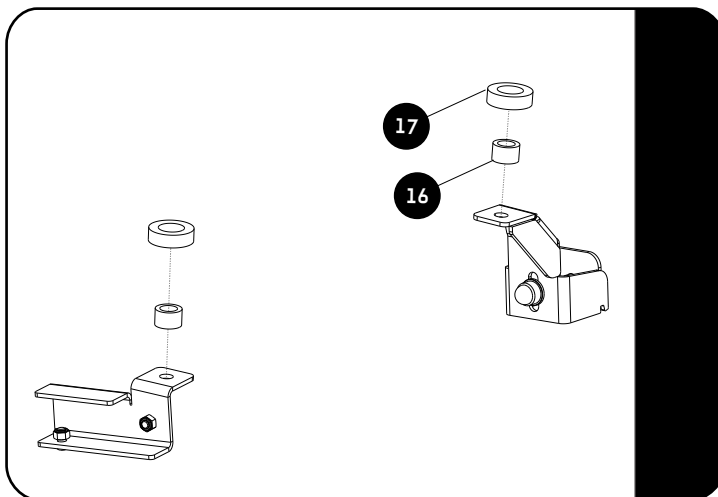

Once all the mounting Brackets are in place and fully tightened drill the holes from the bottom of the brackets using a 6mm drill bit.

From the top of the roof use a 20mm Hole saw and drill the roof from the top to seat the Spacers (Item 16). Place the spacers in the holes drilled and place the rubber foam Washer (Item 17) over the Spacers.

2.3

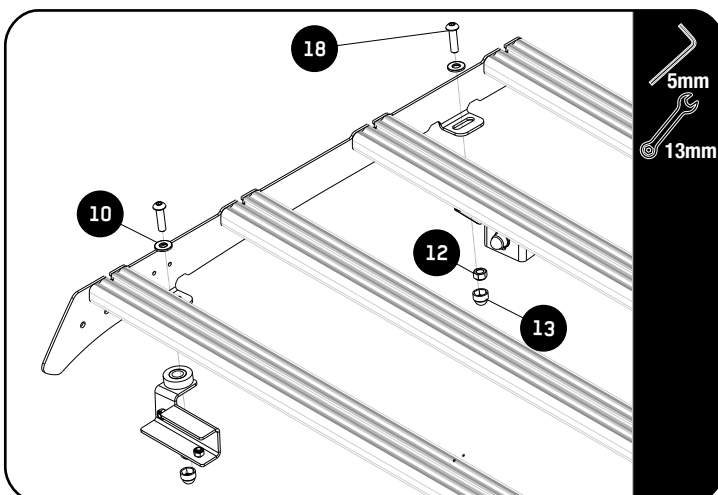

Secure the Tray to the Roof using M8 x 30 Button Head Screw, M8 x 19 x 2 Flat Washers and M8 Nyloc Nut. (Items 10, 12,18).

Do this for LH and RH side and fully tighten the M8 x 30 Button Head Screws.

Place M8 Nut Caps (Item 13) over all Fasteners.

Refit Bolts removed in 2.1.



Tightening Torque:

M8 : 15-20Nm / 11.06 ft lb - 14.75 ft lb

3

FIT AND SECURE

LIGHT BAR WIND FAIRING ASSEMBLY

3.1

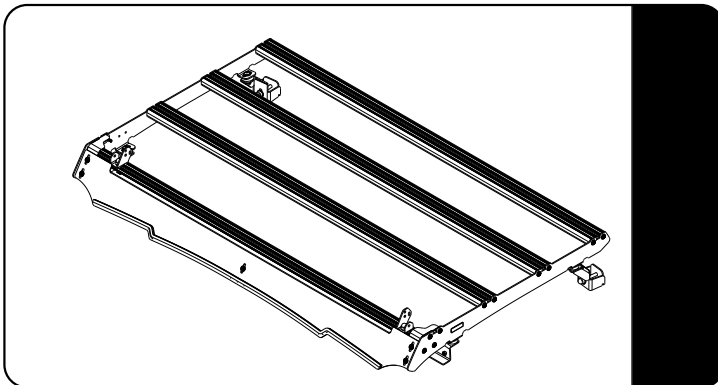

Refer to fitment guide RRAC242

STANDARD WIND FAIRING ASSEMBLY

3.2

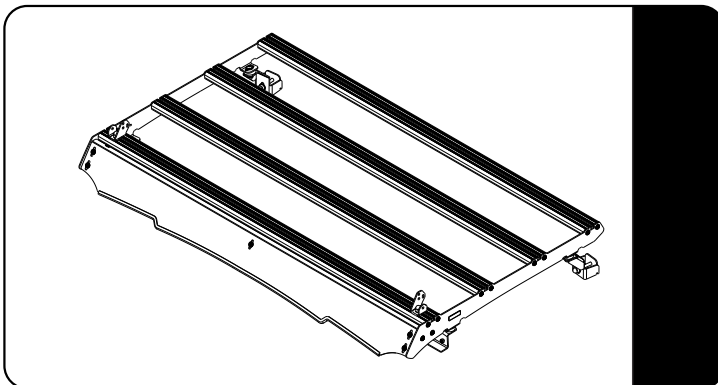

Refer to fitment guide RRAC243

4

COMPLETION

4.1

Congratulations! You did it. Take a step back and admire your work!



8

INSTALL OTHER VEHICLE AND RACK ACCESSORIES

Now's the time to visit your favorite Front Runner dealer in person or online.

IMPORTANT!

FRONT RUNNER RACK KITS OFTEN HAVE A HIGHER LOAD RATING THAN THE VEHICLES THEY ARE MOUNTED TO. PLEASE REFER TO YOUR SPECIFIC VEHICLE MANUFACTURER FOR A RECOMMENDED ROOF RATING. FRONT RUNNER CANNOT BE RESPONSIBLE FOR IMPROPER LOADING BEYOND THE VEHICLE MANUFACTURER'S STATED LOAD CAPACITY.

Be sure to tag us. We love to see our gear in action! #FrontRunnerOutfitters #BornToRoam

Share your adventures on: