

# START HERE!

## READ ME FIRST

Don't be a hero and muscle through this installation without reading these fitting instructions first! Improper installation of this gear may void certain aspects of your warranty.

Before you begin, take a moment and open all your Front Runner rack kit boxes and gather the assembly instructions for the various components.

A complete kit will contain:

1. A Front Runner Mounting System specific to your vehicle
2. A Front Runner Rack Tray or Load Bar Slats

This document will guide you through the assembly of the mounting system and assist you in fitting the roof rack tray or load bars to your specific vehicle.

Please refer to the next page for a list of all the components, quantities and tools required.

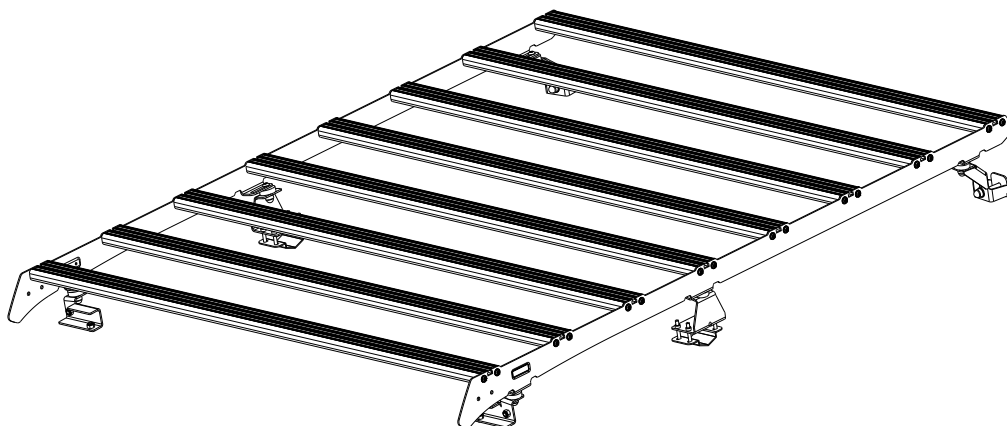

### IMPORTANT WARNING!

IT IS CRITICAL THAT ALL FRONT RUNNER PRODUCTS BE PROPERLY AND SECURELY ASSEMBLED AND ATTACHED TO YOUR VEHICLE. IMPROPER ATTACHMENT COULD RESULT IN AN AUTOMOBILE ACCIDENT, AND COULD CAUSE SERIOUS BODILY INJURY OR DEATH. YOU ARE RESPONSIBLE FOR ASSEMBLING AND SECURING ALL FRONT RUNNER PRODUCTS TO YOUR VEHICLE, CHECKING THE ATTACHMENTS PRIOR TO USE, AND PERIODICALLY INSPECTING THE PRODUCTS FOR ADJUSTMENT, WEAR AND DAMAGE. THEREFORE, YOU MUST READ AND UNDERSTAND ALL OF THE INSTRUCTIONS AND PRECAUTIONS SUPPLIED WITH YOUR FRONT RUNNER PRODUCT PRIOR TO INSTALLATION OR USE. IF YOU DO NOT UNDERSTAND ALL OF THE INSTRUCTIONS AND CAUTIONS, OR IF YOU HAVE NO MECHANICAL EXPERIENCE AND ARE NOT THOROUGHLY FAMILIAR WITH THE INSTALLATION PROCEDURES, YOU SHOULD HAVE THE PRODUCT INSTALLED BY A PROFESSIONAL INSTALLER OR OTHER QUALIFIED PERSONNEL.

**NOTE:** Front Runner will not be responsible for any damage caused by the failure to install the product according to these instructions.

Please call us if you have any questions about the installation of this product.



# 1 GET ORGANIZED

## IN THE BOX

1	1 X	Foot Rail LH
2	1 X	Foot Rail RH
3	4 X	Standard Slat
4	32 X	M6 X 25 Thread Forming Screw
5	2 X	Internal Center Mounting Bracket
6	2 X	Center Clamping Bracket
7	8 X	M6 X 40 Button Head Screw
8	2 X	Internal Mounting Bracket Front LH
9	4 X	M8 X 12 Button Head Screw
10	12 X	M8 Nyloc Nut
11	1 X	Internal Mounting Bracket Rear LH
12	1 X	Internal Mounting Bracket Rear RH
13	2 X	Clamping Plate Rear
14	2 X	M8 X 60 Hex Bolt
15	8 X	M8 X 19 X 2 Flat Washer
16	8 X	M8 Nut Cap
17	6 X	19 X 12.58 X 12 Spacer
18	6 X	Foam Rubber Washer
19	6 X	M8 X 30 Button Head Screw

## TOOLS NEEDED

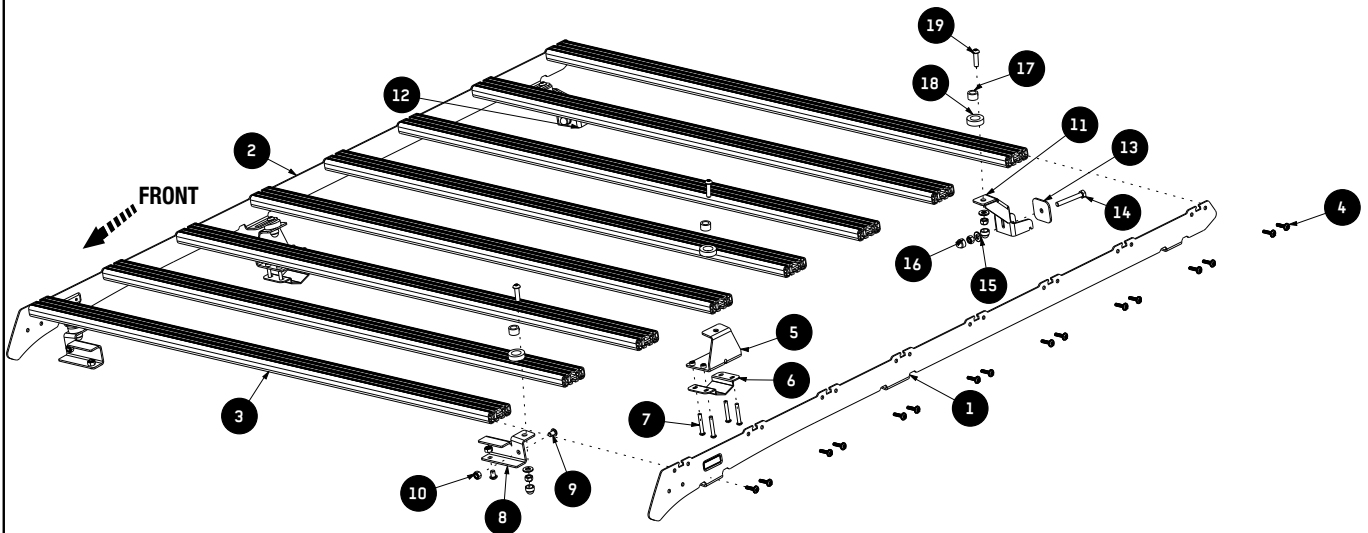
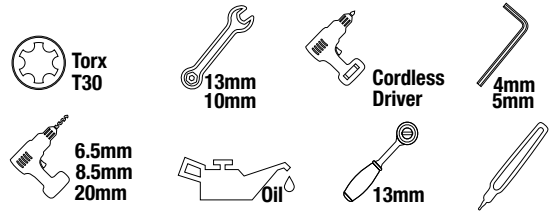

## 2 ASSEMBLY

2

2.1

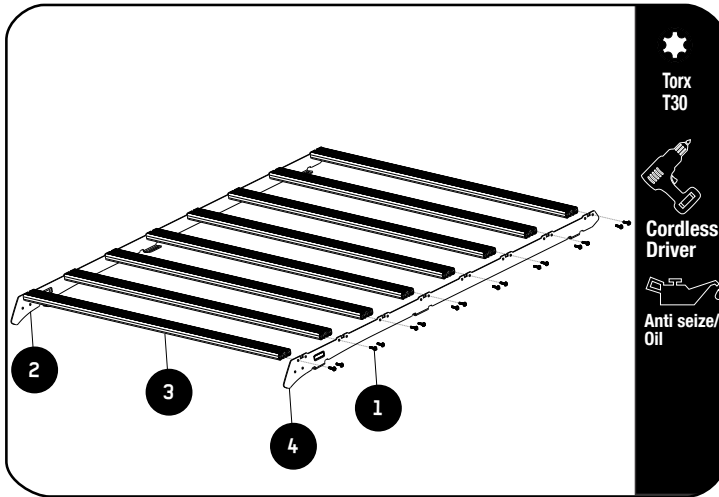

Fit 7 Slimsport Slats (Item 3) to the Foot Rails (Item 1 & 2) using 32 x M6 x 25 Thread Forming Screws (Item 4) as shown.

Apply a little Anti Seize / oil on screw threads before inserting. Note these are thread forming screws.

Tightening Torque 8-10Nm / 5.9 ft lb - 7.38 ft lb. Take care when using a cordless driver.

## 3 FIT AND SECURE

3.1



Start by removing the 4 bolts holding the roof in place to gain access behind the roof and keep aside to refit.

Look on Youtube for assistance.

3.2

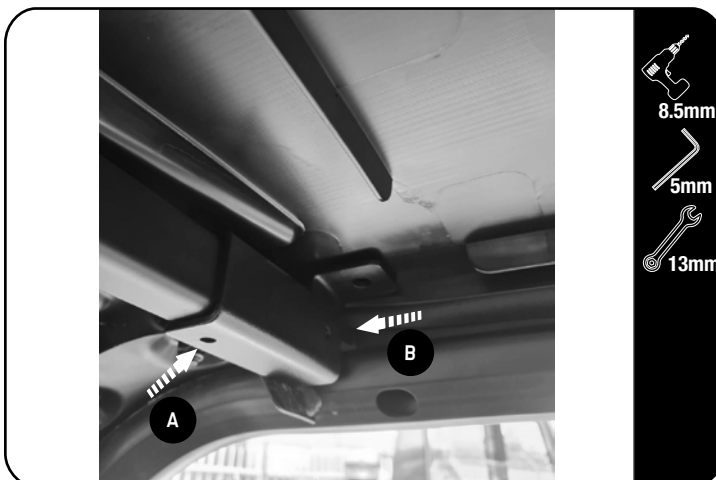

Place the Front Mounting Bracket (Item 8) onto the front Cross member and secure the Front mounting Bracket To the OEM hole (A) Using M8 x 12 Button Head Bolt and M8 Nyloc Nut (Item 9 & 10). Fully Tighten.

Drill the second hole (B) using a 8.5mm drill and secure using M8 x 12 Button Head Bolt and M8 Nyloc Nut (Item 9 & 10). Fully Tighten.

Tightening Torque:

M8 : 15-20Nm / 11.06 ft lb - 14.75 ft lb

3

FIT AND SECURE

3.3



Place the Rear Mounting Bracket (Item 11 & 12) onto the rear Cross member and place the Rear Clamping Plate (Item 13) at the back of the crossmember as shown.

Secure the Rear mounting Bracket To the Cross member Using M8 x 60 Hex Bolt , M8x19x2 Flat Washer and M8 Nyloc Nut (Item 10,14&15) as shown.

Do this Both LH and RH side.

Move the Bracket all the way to the outer edge of the cross member and fully tighten.



**Tightening Torque:**

M8 : 15-20Nm / 11.06 ft lb - 14.75 ft lb

3.4

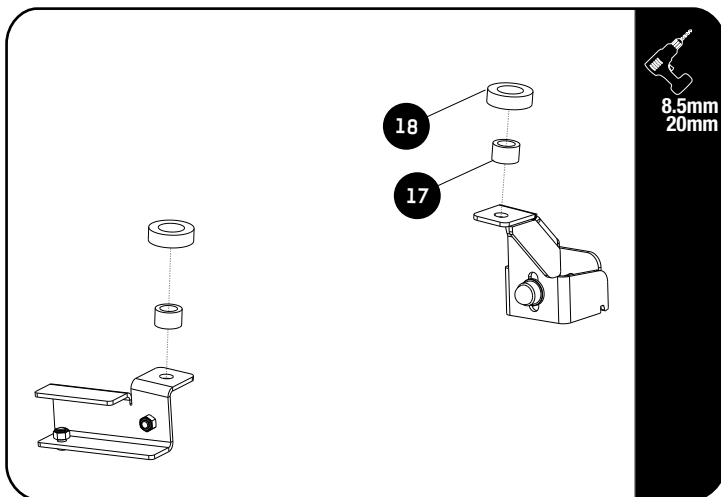

Once the Front and Rear mounting Brackets are in place and fully tightened. Drill the holes from the bottom of the brackets using a 6.5mm drill bit.

From the top of the roof use a 20mm Hole saw and drill the roof from the top to seat the Spacers (Item 17).Place the spacers in the holes drilled and place the rubber foam Washer (Item 18) over the Spacers.

3.5

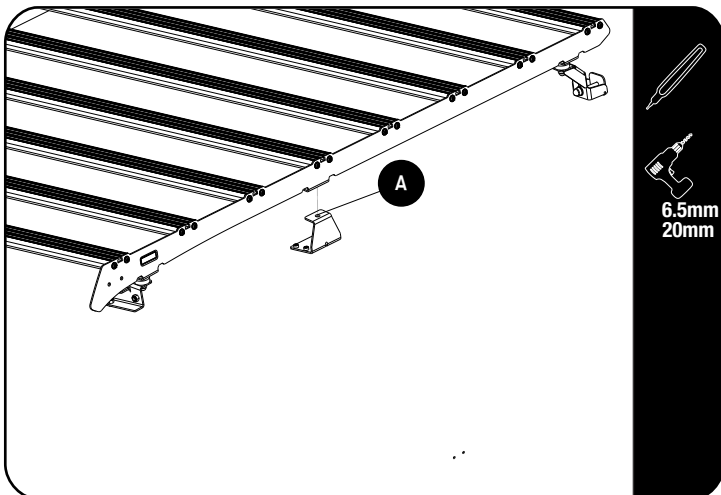

Loosley fit the Slimsport tray to the Front and Rear Brackets. DO NOT FULLY TIGHTEN.Do This LH and RH side.

Mark the Center of the Center hole to the roof.

Remove the Slimsport tray From the Roof.

Drill the Marks (A) made using a 6.5mm drill and open the Holes to a 20mm hole using a Hole saw.



3

**FIT AND SECURE**

3.6

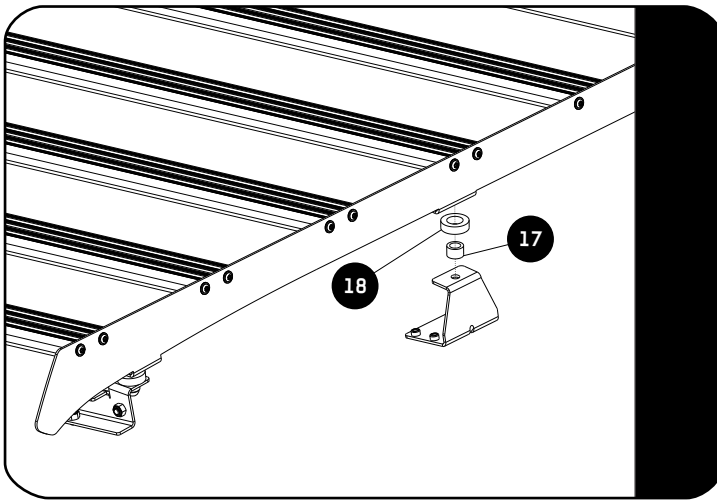

⌛ Before you Refit the Slimsport Tray make sure that the Center Mounting Bracket Spacer and Rubber Foam Washer (Item 17 & 18) is fitted to the roof as shown.

3.7

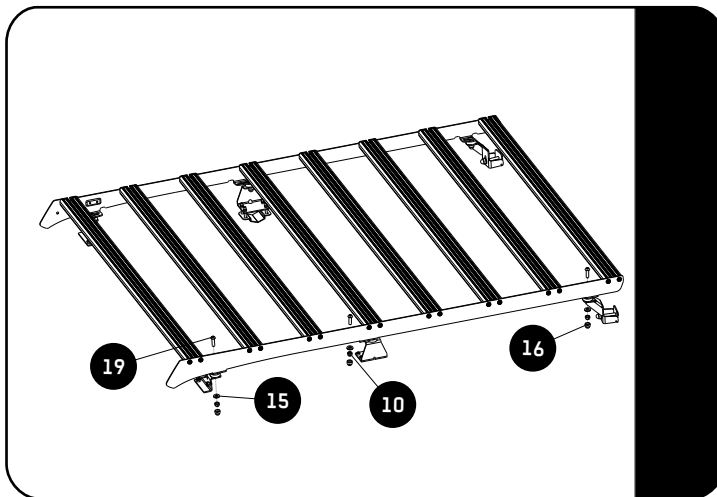

⌛ Once all the spacers and Rubber Foam washers are in place fit your Slimsport Rack to the Mounting Brackets as shown using M8 x 30 Button head Bolt, M8 x 19 x 2 Flat washer and M8 Nyloc Nut (Item 10,15 & 19).DO NOT FULLY TIGHTEN.

Do this LH and RH side.

3.8

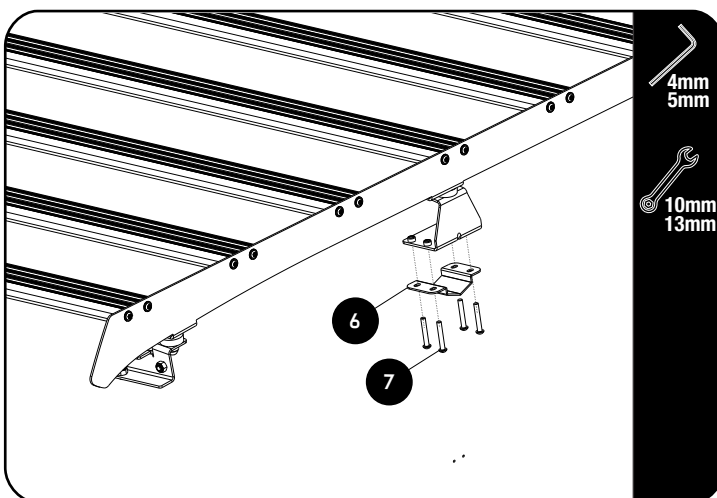

⌛ Once all the M8 x 30 Button Head bolts are in place fit the Center Clamping Bracket (Item 6) to the Center Bracket using M6 x 40 Button Head Screws as shown and fully tighten.



**Tightening Torque:**

**M6 : 8-10Nm / 5.9 ft lb - 7.38 ft lb**

Fully Tighten The M8 x 30 Button Head Bolts fitted in 3.7 and Place the M8 Nut Caps (Item 16) where needed.



**Tightening Torque:**

**M8 : 15-20Nm / 11.06 ft lb - 14.75 ft lb**

4

## FIT AND SECURE

### LIGHT BAR WIND FAIRING ASSEMBLY

4.1

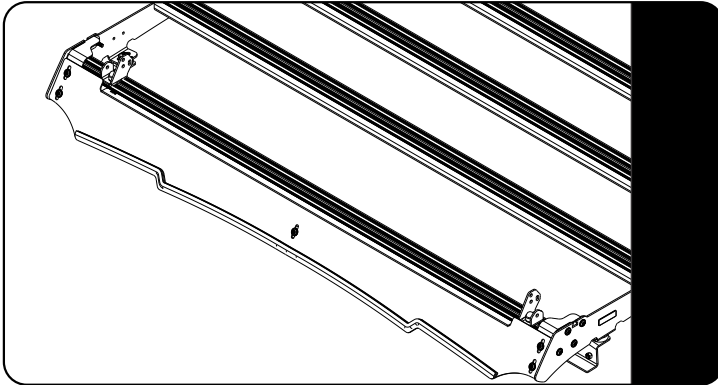

Refer to fitment guide RRAC242

### STANDARD WIND FAIRING ASSEMBLY

4.2

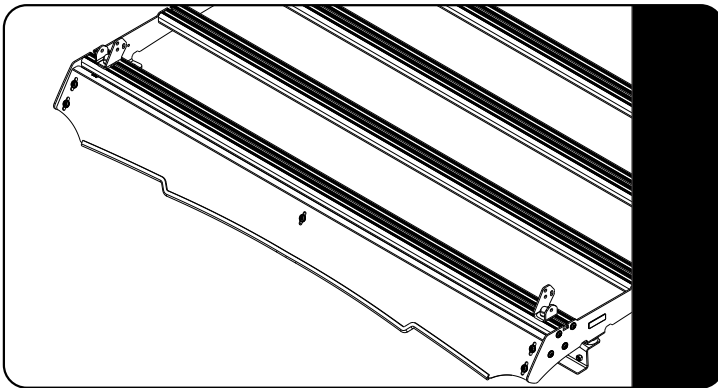

Refer to fitment guide RRAC243

5

## COMPLETION

5.1

Congratulations! You did it. Take a step back and admire your work!



6

## INSTALL OTHER VEHICLE AND RACK ACCESSORIES

Now's the time to visit your favorite Front Runner dealer in person or online.

### IMPORTANT!

FRONT RUNNER RACK KITS OFTEN HAVE A HIGHER LOAD RATING THAN THE VEHICLES THEY ARE MOUNTED TO. PLEASE REFER TO YOUR SPECIFIC VEHICLE MANUFACTURER FOR A RECOMMENDED ROOF RATING. FRONT RUNNER CANNOT BE RESPONSIBLE FOR IMPROPER LOADING BEYOND THE VEHICLE MANUFACTURER'S STATED LOAD CAPACITY.

Be sure to tag us. We love to see our gear in action! #FrontRunnerOutfitters #BornToRoam

Share your adventures on:  