

# START HERE!

## READ ME FIRST

Don't be a hero and muscle through this installation without reading these fitting instructions first! Improper installation of this gear may void certain aspects of your warranty.

Before you begin, take a moment and open all your Front Runner Rack Kit boxes and gather the assembly instructions for the various components.

A complete kit will contain:

1. Front Runner Slimsport Kit

This document will guide you through the assembly of the Mounting System and assist you in fitting the Rack Tray or Load Bars to your specific vehicle. Please refer to the next page for a list of all the components, quantities and tools required.

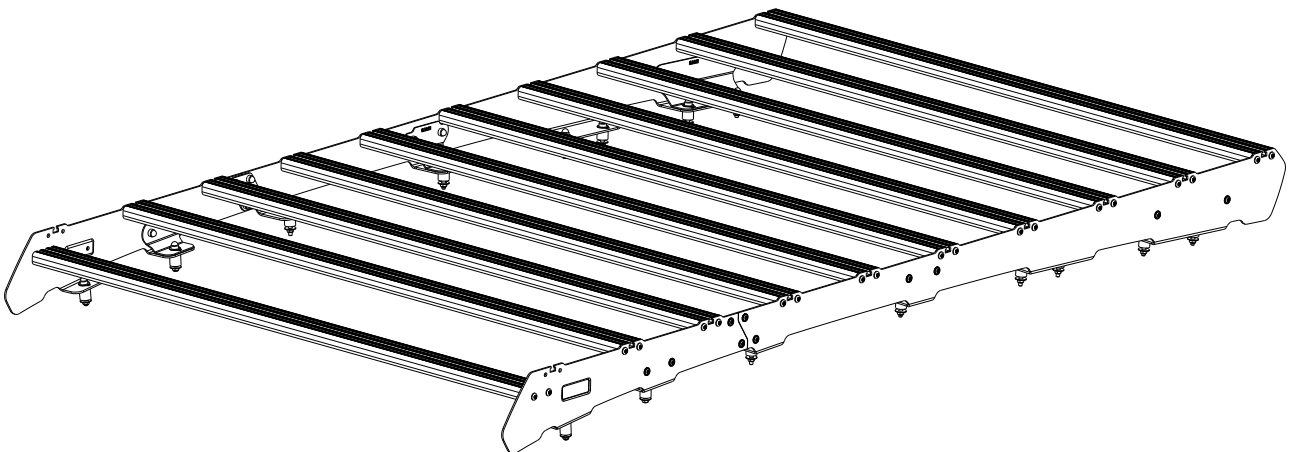

### IMPORTANT WARNING!

IT IS CRITICAL THAT ALL FRONT RUNNER PRODUCTS BE PROPERLY AND SECURELY ASSEMBLED AND ATTACHED TO YOUR VEHICLE. IMPROPER ATTACHMENT COULD RESULT IN AN AUTOMOBILE ACCIDENT, AND COULD CAUSE SERIOUS BODILY INJURY OR DEATH. YOU ARE RESPONSIBLE FOR ASSEMBLING AND SECURING ALL FRONT RUNNER PRODUCTS TO YOUR VEHICLE, CHECKING THE ATTACHMENTS PRIOR TO USE, AND PERIODICALLY INSPECTING THE PRODUCTS FOR ADJUSTMENT, WEAR AND DAMAGE. THEREFORE, YOU MUST READ AND UNDERSTAND ALL OF THE INSTRUCTIONS AND PRECAUTIONS SUPPLIED WITH YOUR FRONT RUNNER PRODUCT PRIOR TO INSTALLATION OR USE. IF YOU DO NOT UNDERSTAND ALL OF THE INSTRUCTIONS AND CAUTIONS, OR IF YOU HAVE NO MECHANICAL EXPERIENCE AND ARE NOT THOROUGHLY FAMILIAR WITH THE INSTALLATION PROCEDURES, YOU SHOULD HAVE THE PRODUCT INSTALLED BY A PROFESSIONAL INSTALLER OR OTHER QUALIFIED PERSONNEL.

**NOTE:** Front Runner will not be responsible for any damage caused by the failure to install the product according to these instructions.

Please call us if you have any questions about the installation of this product.



# 1 GET ORGANIZED

## IN THE BOX

1	2 X	Foot Rail Front - 1 LH & 1 RH
2	2 X	Foot Rail Rear - 1 LH & 1 RH
3	2 X	Joiner Plate
4	2 X	Stiffener Plate Rear - 1 LH & 1 RH
5	2 X	Stiffener Plate Front - 1 LH & 1 RH
6	2 X	Stiffener Plate Mid - 1 LH & 1 RH
7	10 X	Narrow Slat 1145mm
8	40 X	M6 x 25 Thread Forming Screw
9	20 X	M6 x 16 Button Head Flange Bolt
10	36 X	M6 Nyloc Nut
11	36 X	M6 Nut Cap
12	32 X	M6 x 19 x 1 Flat Washer
13	16 X	M6 x 40 Hex Bolt
14	4 X	19 x 12.58 x 24 Spacer
15	4 X	19 x 12.58 x 15 Spacer
16	8 X	19 x 12.58 x 18 Spacer

## TOOLS NEEDED

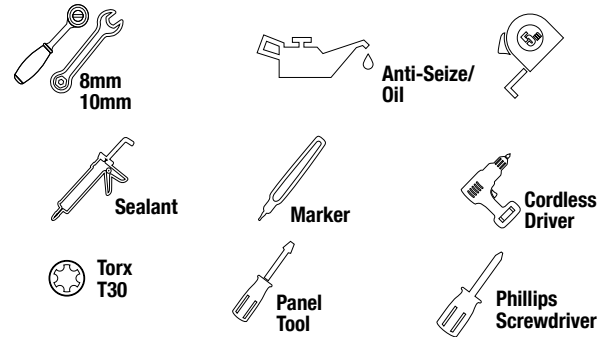
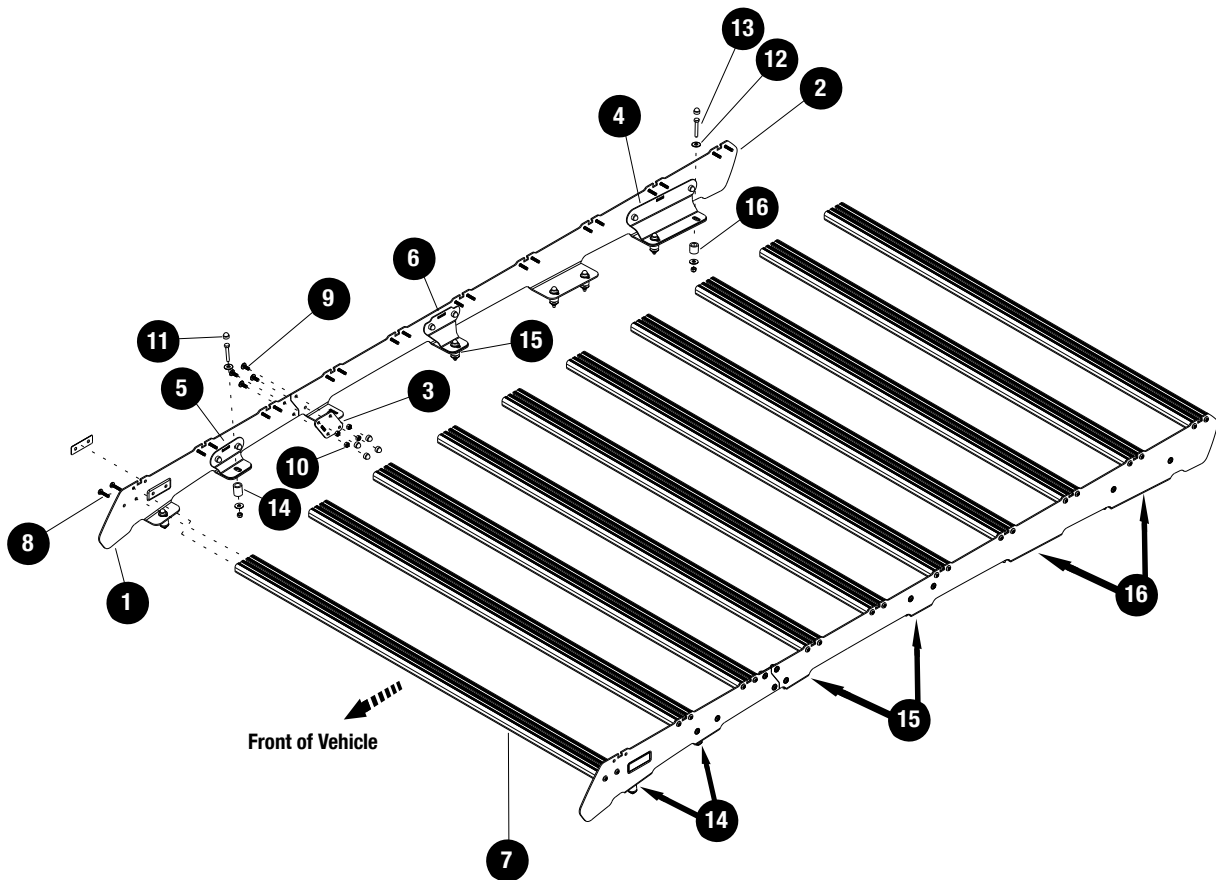

FIGURE 1.1



2

FIT AND SECURE

2.1



Start by dropping the vehicle's headliner.



Look online for videos to assist with this step.

2.2

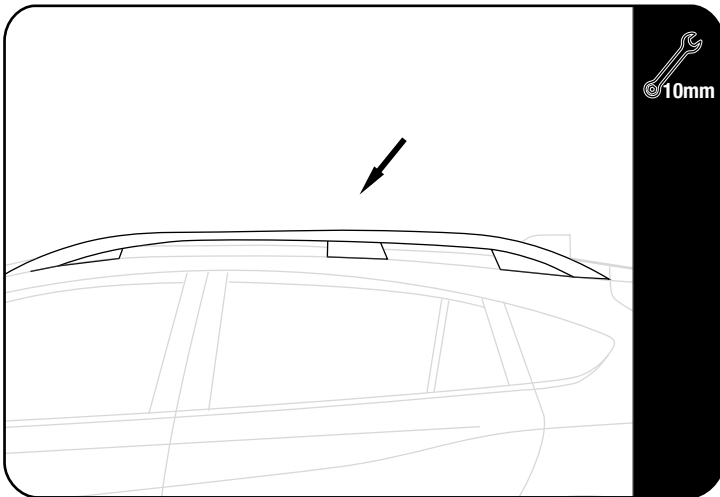

Remove the vehicle's Factory Roof Rails.

2.3

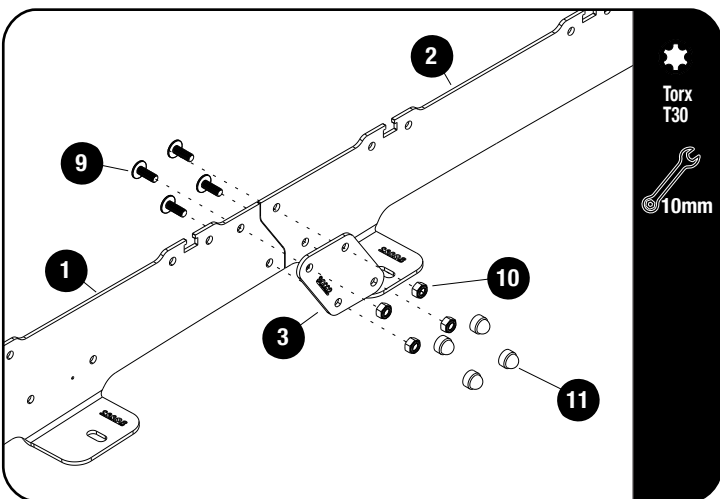

On a suitable surface, loosely assembly the Front and Rear Foot Rails (Items 1 & 2), using the Joiner plates (Item 3) and four M6 x 16 Flange Button Head Bolts and four M6 Nyloc Nuts (Items 9 & 10). Fully tighten.

Do this to both LH & RH Foot Rails.



Tightening Torque:

M6 : 8-10Nm / 5.9 ft lb - 7.38 ft lb

Place a M6 Nut Cap (Item 11) over each M6 Nyloc Nut.

2.4

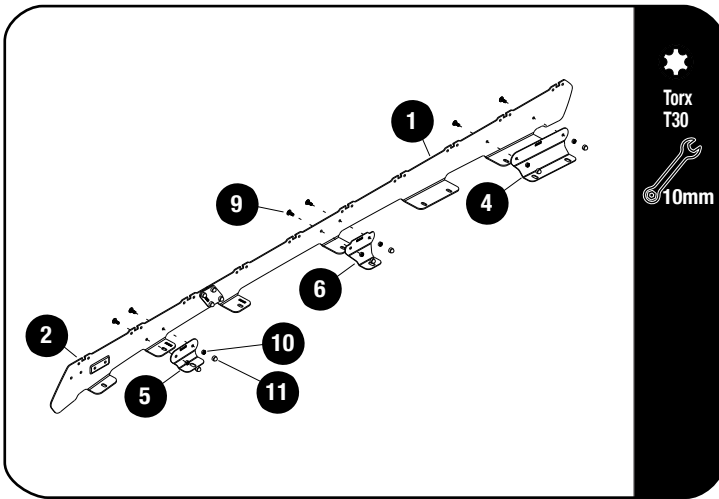

Secure the Front, Mid and Rear Stiffener Brackets (Items 4, 5 & 6) to the Foot Rails' sides (Item 1 & 2), using M6 x 16 Flange Button Heads and M6 Nyloc Nuts (Items 9 & 10), as shown. Fully tighten.

Do this with both LH & RH Foot Rails.



**Tightening Torque:**

M6 : 8-10Nm / 5.9 ft lb - 7.38 ft lb

Place a M6 Nut Cap (Item 11) over each M6 Nyloc Nut.

2.5

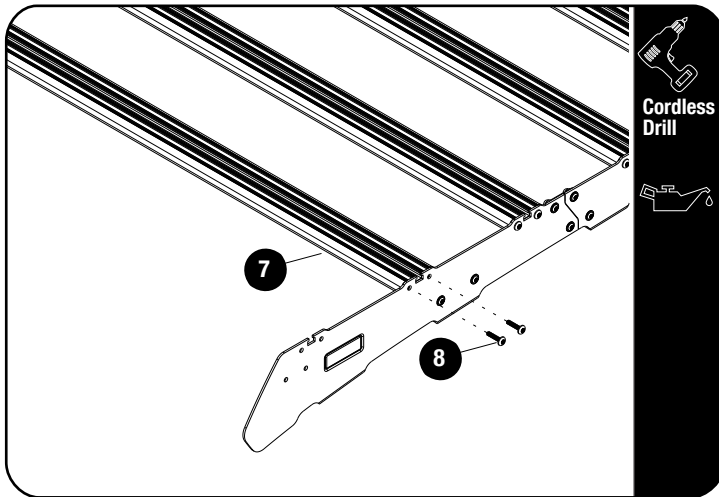

**NOTE:** Do not fit the front slat yet.



Use a little anti-seize/oil on screw threads before inserting. Note these are Thread Forming Screws.



Assemble nine Narrow Slats (Item 7) to assembly 2.3 using M6 x 25 Thread Forming Screws (Item 8).



**Tightening Torque:**

M6 : 8-10Nm / 5.9 ft lb - 7.38 ft lb

2.6

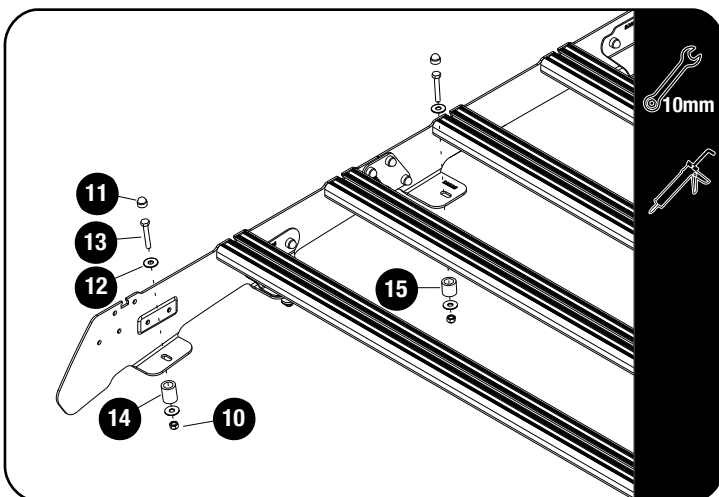

Place Spacers (Items 14, 15 & 16) centrally over all the OEM holes. See Fig 1.1 for spacer placement. Fill all the tube spacers with a suitable sealant.

With the help of a friend, position the rack onto the Spacers.

Center the rack on the vehicle.

Secure the rack by inserting a M6 x 40 Hex Bolt with a M6 x 19 x 1 Flat Washer (Items 13 & 12) into each of the OEM Mounting Holes.

Use a M6 x 19 x 1 Flat Washer and M6 Nyloc Nuts (Items 12 & 10) to secure each of the sixteen fixing points. Fully tighten.



**Tightening Torque:**

M6 : 8-10Nm / 5.9 ft lb - 7.38 ft lb

Place M6 Nut Caps (Item 11) over all Hex Bolts.

2.7

**STANDARD WIND FAIRING ASSEMBLY**

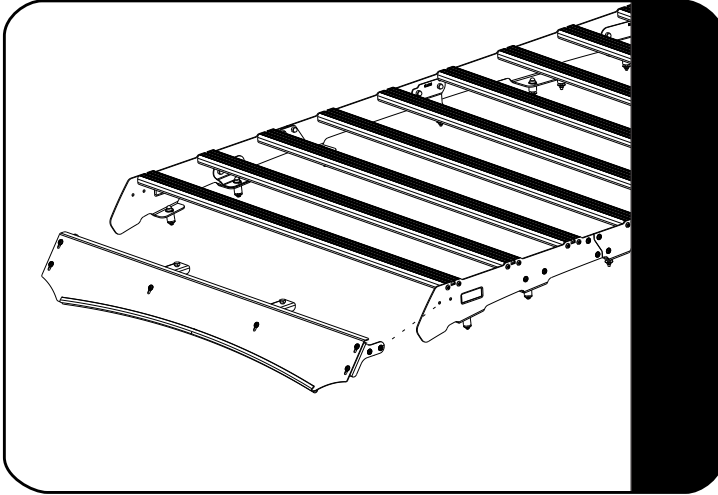

Refer to fitment guide RRAC327

2.8

**LIGHT BAR WIND FAIRING ASSEMBLY**

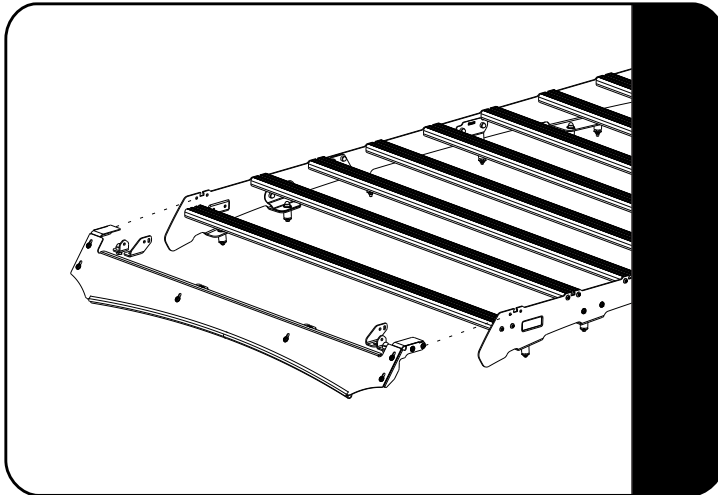

Refer to fitment guide RRAC328

3

## COMPLETION

3.1

Congratulations! You did it. Take a step back and admire your work!



4

## INSTALL OTHER VEHICLE AND RACK ACCESSORIES

Now's the time to visit your favorite Front Runner dealer in person or online.

### IMPORTANT!

FRONT RUNNER RACK KITS OFTEN HAVE A HIGHER LOAD RATING THAN THE VEHICLES THEY ARE MOUNTED TO. PLEASE REFER TO YOUR SPECIFIC VEHICLE MANUFACTURER FOR A RECOMMENDED ROOF RATING. FRONT RUNNER CANNOT BE RESPONSIBLE FOR IMPROPER LOADING BEYOND THE VEHICLE MANUFACTURER'S STATED LOAD CAPACITY.

Be sure to tag us. We love to see our gear in action! #FrontRunnerOutfitters #BornToRoam

Share your adventures on: 