

START HERE!

READ ME FIRST

Don't be a hero and muscle through this installation without reading these fitting instructions first! Improper installation of this gear may void certain aspects of your warranty.

Before you begin, take a moment and open all your Front Runner rack kit boxes and gather the assembly instructions for the various components.

A complete kit will contain:

1. A Front Runner Slimsport Roof Rack
2. A Front Runner Wind Fairing

This document will guide you through the assembly of the mounting system and assist you in fitting the roof rack tray or load bars to your specific vehicle.

Please refer to the next page for a list of all the components, quantities and tools required.

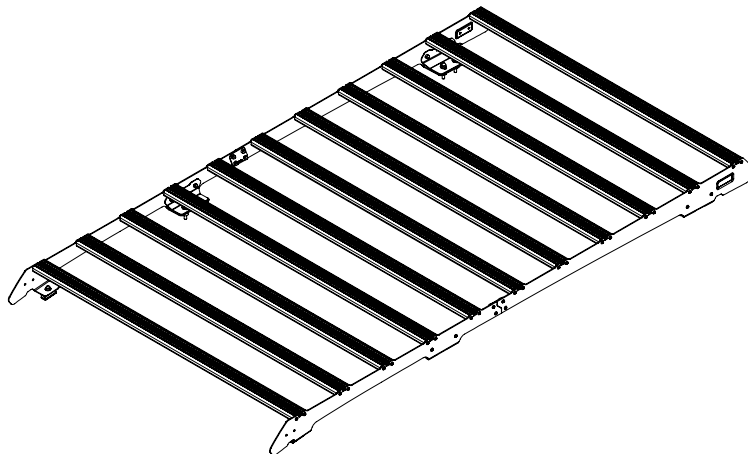

IMPORTANT WARNING!

IT IS CRITICAL THAT ALL FRONT RUNNER PRODUCTS BE PROPERLY AND SECURELY ASSEMBLED AND ATTACHED TO YOUR VEHICLE. IMPROPER ATTACHMENT COULD RESULT IN AN AUTOMOBILE ACCIDENT, AND COULD CAUSE SERIOUS BODILY INJURY OR DEATH. YOU ARE RESPONSIBLE FOR ASSEMBLING AND SECURING ALL FRONT RUNNER PRODUCTS TO YOUR VEHICLE, CHECKING THE ATTACHMENTS PRIOR TO USE, AND PERIODICALLY INSPECTING THE PRODUCTS FOR ADJUSTMENT, WEAR AND DAMAGE. THEREFORE, YOU MUST READ AND UNDERSTAND ALL OF THE INSTRUCTIONS AND PRECAUTIONS SUPPLIED WITH YOUR FRONT RUNNER PRODUCT PRIOR TO INSTALLATION OR USE. IF YOU DO NOT UNDERSTAND ALL OF THE INSTRUCTIONS AND CAUTIONS, OR IF YOU HAVE NO MECHANICAL EXPERIENCE AND ARE NOT THOROUGHLY FAMILIAR WITH THE INSTALLATION PROCEDURES, YOU SHOULD HAVE THE PRODUCT INSTALLED BY A PROFESSIONAL INSTALLER OR OTHER QUALIFIED PERSONNEL.

NOTE: Front Runner will not be responsible for any damage caused by the failure to install the product according to these instructions.

Please call us if you have any questions about the installation of this product.



1 GET ORGANIZED

IN THE BOX

1	1 X	Rear Foot Rail LH
2	1 X	Rear Foot Rail RH
3	2 X	Front Foot Rail - 1LH & 1RH
4	2 X	Joiner Bracket
5	2 X	Front Foot Rail Bracket
6	2 X	Rear Foot Rail Bracket
7	11 X	Slimsport Slat - 1205mm Long (ALE077)
8	2 X	Bottom Spacer - 10mm HDPE
9	2 X	Top Spacer - 10mm HDPE
10	2 X	M6x19x1 Flat Washer
11	2 X	M6x30 Countersunk Cap Screw
12	18 X	M6 Nyloc Nut
13	18 X	M6 Nut Cap
14	8 X	Tube Spacer 19x12.58x20
15	1 X	Double Sided Tape Strip
16	8 X	M8x19x2 Flat Washer
17	8 X	M8x45 Hex Bolt
18	8 X	M8 Nut Cap
19	44 X	M6x20 Button Head Bolt
20	16 X	M6x16 Button Head Bolt
21	1 X	Thread Locker

TOOLS NEEDED

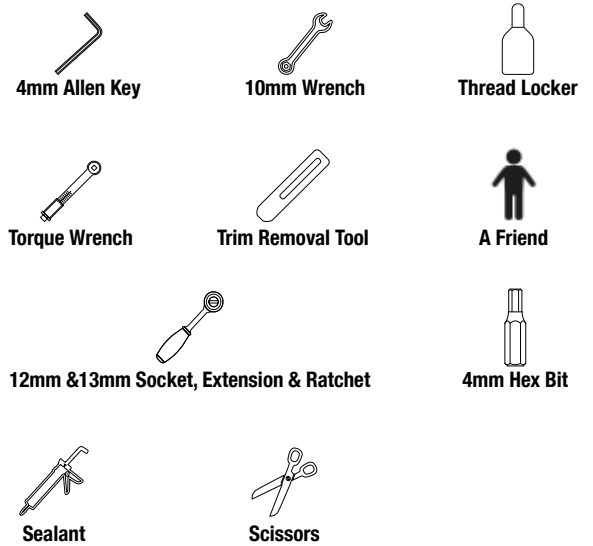
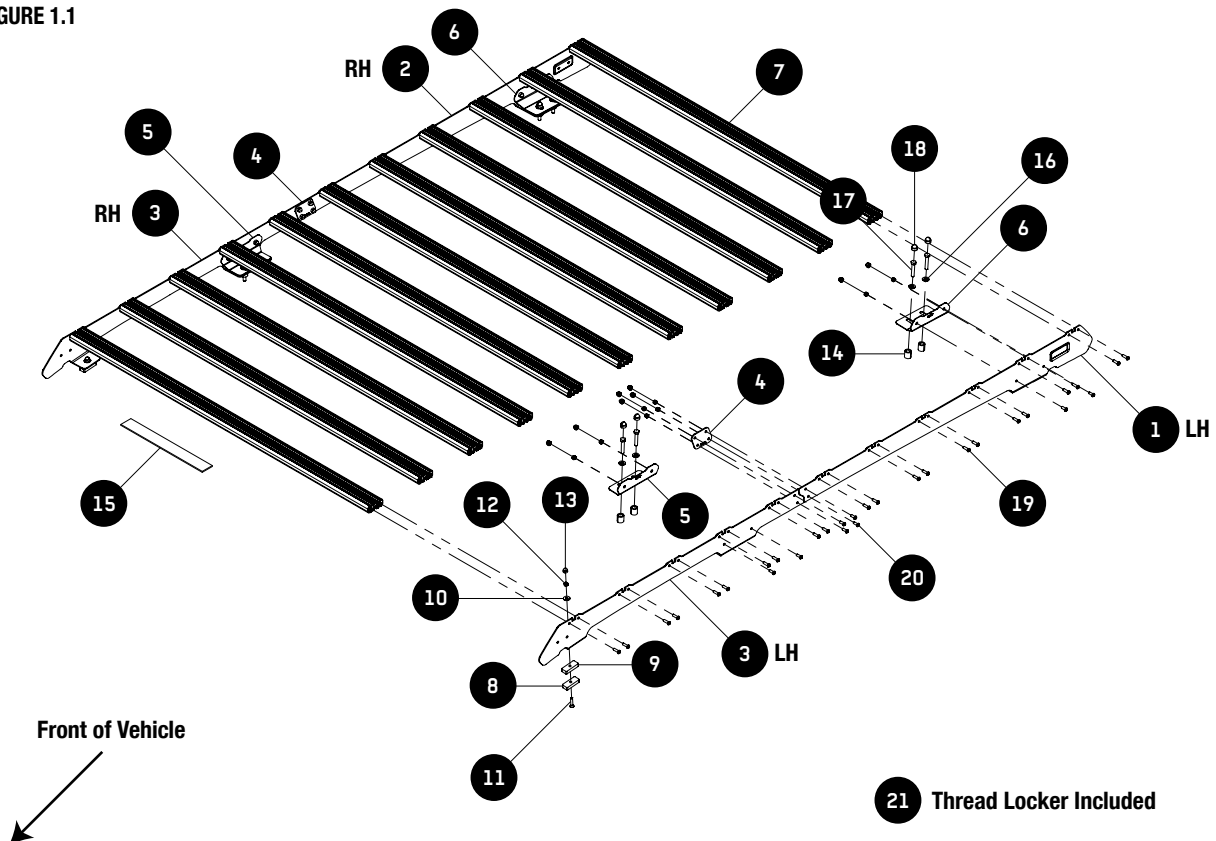

FIGURE 1.1



2

FIT AND SECURE

2.1

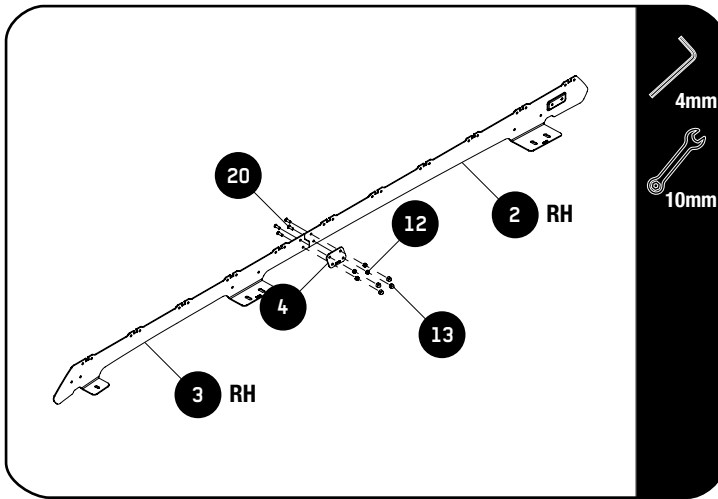

Assemble the Front & Rear RH Foot Rails (Item 3RH & 2RH) by fastening the Joiner Bracket (Item 4) to the Foot Rails.
Fully tighten the Joiner Bracket (Item 4) by fastening the M6x16 Button Head Bolts & M6 Nyloc Nuts (Items 20 & 12) as shown.



Tightening Torque:

M6 : 8-10Nm / 5.9 ft lb - 7.38 ft lb

Place the M6 Nut Caps (Item 13) over the M6 Nyloc Nuts (Item 12).

Repeat this step for the left side (Item 1LH & 3LH).

2.2

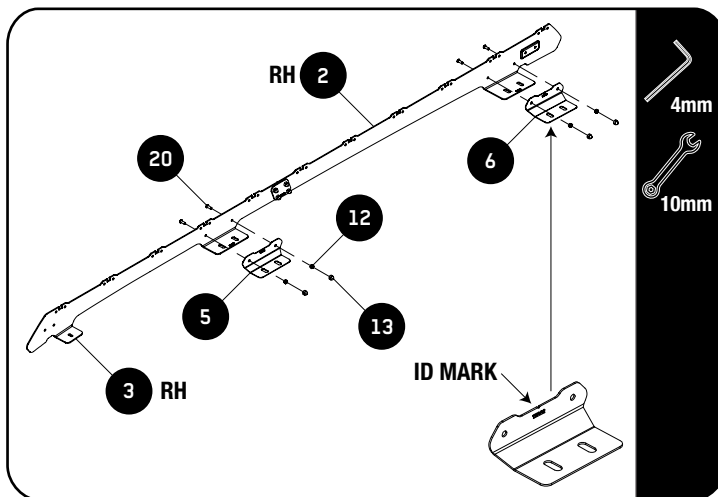

Assemble the Front & Rear Support Brackets (Item 5 & 6) to the Foot Rails from the step 2.1.

Fit the Support Brackets to the sides of the Foot Rails by fully tightening the M6x16 Button Head Bolts & M6 Nyloc Nuts (Items 20 & 12) as shown.

Tightening Torque:

M6 : 8-10Nm / 5.9 ft lb - 7.38 ft lb

Place M6 Nut Caps (Item 13) over the M6 Nyloc Nuts (Item 12).

Repeat this step for the left side (Item 1LH & 3LH).

2.3

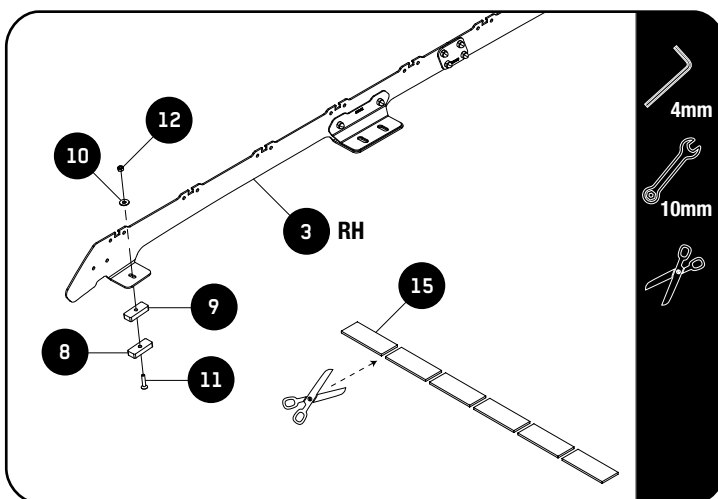

Loosely fit the Top & Bottom Spacers (Item 9 & 8), the spacers will be secured later.

Assemble using the M6x30 Countersunk Cap Screw, Bottom Spacer, Top Spacer, M6x19x1 Flat Washer & M6 Nyloc Nut (Item 11, 8, 9, 10 & 12) as shown.

Repeat this step for the left side (Item 1LH & 3LH).

Cut the Double Sided Tape Strip (Item 15) into six 50mm strips and set aside to be used in Step 2.7.

2

FIT AND SECURE

2.4

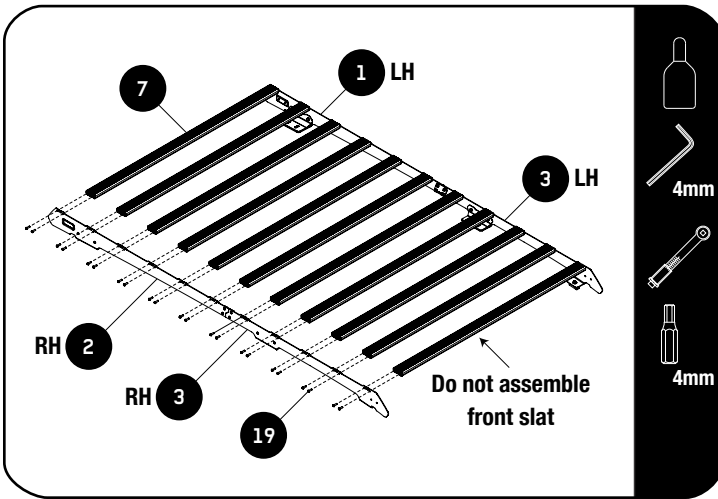

NOTE: Do not assemble the front Slat.



Apply a drop of Thread Locker on each M6x20 Button Head Bolt before securing the slats.



Assemble the Slimsport Slats (Item 7) to the Rear & Front Foot Rails as shown.

Fully tighten the M6x20 Button Head Bolts (Item 19) to the Slimsport Slats (Item 7) as shown.

Repeat this step for the left side (Item 1LH & 3LH).



Tightening Torque:

M6 : 8-10Nm / 5.9 ft lb - 7.38 ft lb

2.5



To remove the factory Rails from the vehicle use a plastic trim tool to remove the plastic covers on the side rails.

Remove the front & rear covers on both Roof Rails.

2.6

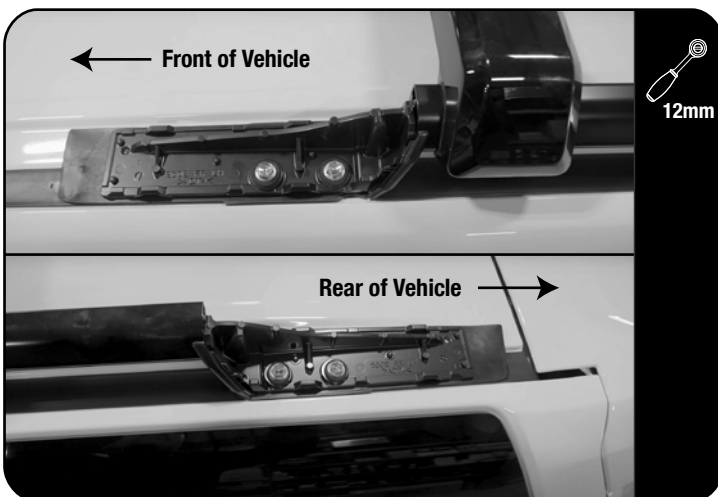

Remove the factory bolts on the front & rear of both Roof Rails, by using a 12mm Socket, Extension and Ratchet.

Remove the front rubber ditch trim piece on both sides of the vehicle and store with factory rails.

The rubber ditch trim pieces are not needed for the fitment of the Slimsport Rack, and can be re-installed when the Rack is removed from the vehicle.

2.7

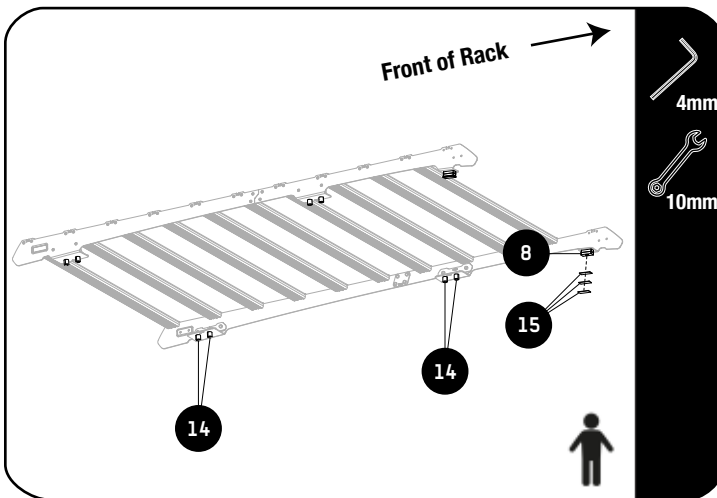

🔄 To determine the positioning of the HDPE spacers located at the front of the rack place the Tube Spacers 19x12.58x20 (Item 14) over the eight factory mounting holes that was used to secure the factory rails.

With the help of a friend place the Slimsport Rack on the roof of the vehicle so that the HDPE spacers position can be determined and the spacers fully tightened from step 2.3.



Tightening Torque:

M6 : 8-10Nm / 5.9 ft lb - 7.38 ft lb

Remove the Rack from the roof and adhere 3 x Double Sided Tape Strips (Item 15) to the underside of the lower Spacer (Item 8) as shown, do not remove the bottom backing strip at this point. Repeat this on both sides.

2.8

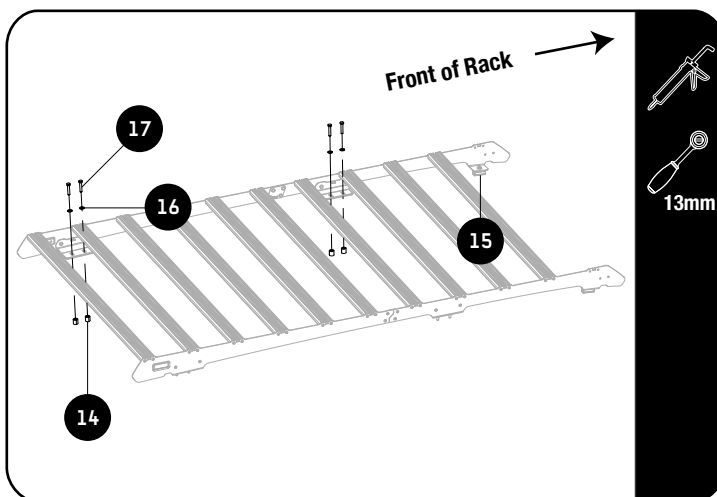

Apply sealant on the inside of all of the Tube Spacers 19x12.58x20 (Item 14) that was placed over the factory mounting holes.

Place the assembled rack onto the spacers and position to align with the foot rail slots.

Center the rack if needed and remove the backing strip from the front mounting points. Secure the rack to the factory mounting holes by using M8x45 Hex Bolts & M8x19x2 Flat Washers (Items 17 & 16).

Fully tighten the M8x45 Hex Bolts (Item 17) to secure the Slimsport Rack to the vehicle.



Tightening Torque:

M8 : 15-20Nm / 11.06 ft lb - 14.75 ft lb

2.9

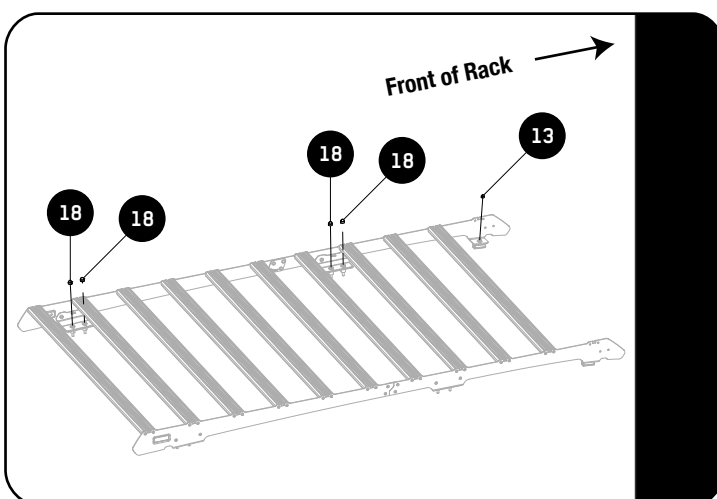

Place the M8 Nut caps & M6 Nut Caps (Items 18 & 13) as shown.

Repeat this on both sides.

3.1

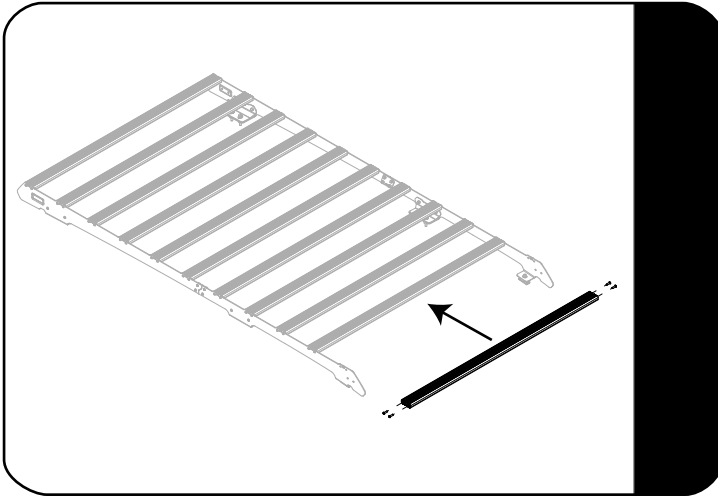

⌚ The front slat position is determined by which wind fairing is used. Refer to the fitment guide received with your wind fairing to confirm the correct position.

3.2

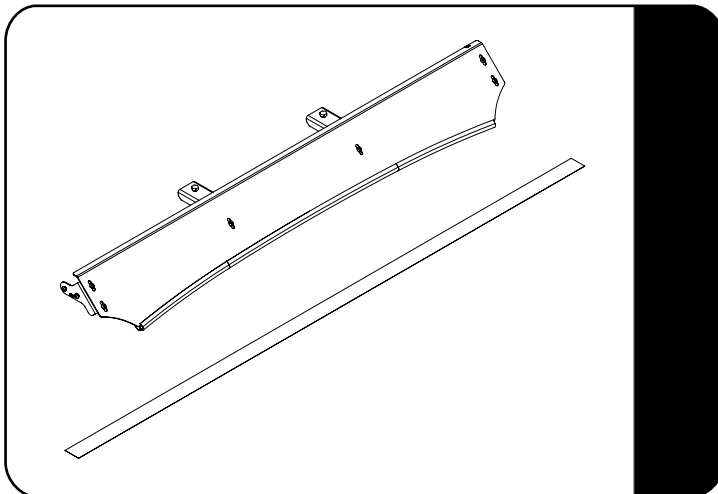

STANDARD WIND FAIRING ASSEMBLY

⌚ Refer to fitment guide RRAC372.

3.3

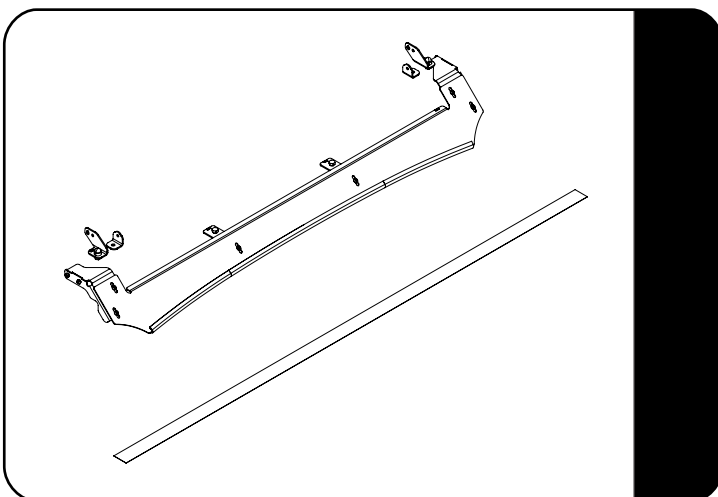

LIGHT BAR WIND FAIRING ASSEMBLY

⌚ Refer to fitment guide RRAC373.

4

COMPLETION

4.1

Congratulations! You did it. Take a step back and admire your work!



5

TAKE A TRIP

After your first trip, check that all nuts, bolts, screws and fittings are tight. Re-tighten where needed. You will find a small amount of settling has happened.

Before going on a trip, check if the nuts, bolts, screws or fittings need to be re-torqued.

6

INSTALL OTHER VEHICLE AND RACK ACCESSORIES

Now's the time to visit your favorite Front Runner dealer in person or online.

IMPORTANT!

FRONT RUNNER RACK KITS OFTEN HAVE A HIGHER LOAD RATING THAN THE VEHICLES THEY ARE MOUNTED TO. PLEASE REFER TO YOUR SPECIFIC VEHICLE MANUFACTURER FOR A RECOMMENDED ROOF RATING. FRONT RUNNER CANNOT BE RESPONSIBLE FOR IMPROPER LOADING BEYOND THE VEHICLE MANUFACTURER'S STATED LOAD CAPACITY.

Be sure to tag us. We love to see our gear in action! #FrontRunnerOutfitters

Share your adventures on: 