

**READ ME !** ⚠

Thank you for purchasing a Front Runner Ford Bronco (2021 - Current) Ladder.

Before you start, take a moment to familiarize yourself with the Fitting Instructions and the included components.

Refer to Page 2 for a list of all the components, quantities and tools required.

**IMPORTANT WARNING!** ⚠

IT IS CRITICAL THAT ALL FRONT RUNNER PRODUCTS BE PROPERLY AND SECURELY ASSEMBLED AND ATTACHED TO YOUR VEHICLE. IMPROPER ATTACHMENT COULD RESULT IN AN AUTOMOBILE ACCIDENT, AND COULD CAUSE SERIOUS BODILY INJURY OR DEATH. YOU ARE RESPONSIBLE FOR ASSEMBLING AND SECURING ALL FRONT RUNNER PRODUCTS TO YOUR VEHICLE, CHECKING THE ATTACHMENTS PRIOR TO USE, AND PERIODICALLY INSPECTING THE PRODUCTS FOR ADJUSTMENT, WEAR AND DAMAGE. THEREFORE, YOU MUST READ AND UNDERSTAND ALL OF THE INSTRUCTIONS AND PRECAUTIONS SUPPLIED WITH YOUR FRONT RUNNER PRODUCT PRIOR TO INSTALLATION OR USE. IF YOU DO NOT UNDERSTAND ALL OF THE INSTRUCTIONS AND CAUTIONS, OR IF YOU HAVE NO MECHANICAL EXPERIENCE AND ARE NOT THOROUGHLY FAMILIAR WITH THE INSTALLATION PROCEDURES, YOU SHOULD HAVE THE PRODUCT INSTALLED BY A PROFESSIONAL INSTALLER OR OTHER QUALIFIED PERSONNEL.

**NOTE:** Front Runner will not be responsible for any damage caused by the failure to install the product according to these instructions.

Please call us if you have any questions about the installation of this product.



# 1 GET ORGANIZED

## IN THE BOX

- |    |     |                              |
|----|-----|------------------------------|
| 1  | 1 X | Top Step Bracket             |
| 2  | 1 X | Top Mounting Bracket         |
| 3  | 2 X | M6 x 12 Button Head Screw    |
| 4  | 2 X | M8 x 20 Button Head Screw    |
| 5  | 2 X | M8 x 30 Button Head Screw    |
| 6  | 2 X | M8 Nyloc Nut                 |
| 7  | 2 X | Ladder Sides (517mm)         |
| 8  | 2 X | Ladder Rung Steps (226mm)    |
| 9  | 1 X | Bottom Mounting Bracket      |
| 10 | 6 X | M6 x 16 Button Head Screw    |
| 11 | 8 X | M6 Nyloc Nut                 |
| 12 | 8 X | M6 Nut Cap                   |
| 13 | 4 X | M6 x 25 Thread Forming Screw |
| 14 | 1 X | Mounting Bracket RH side     |
| 15 | 2 X | Mounting Bracket LH Side     |

## TOOLS NEEDED

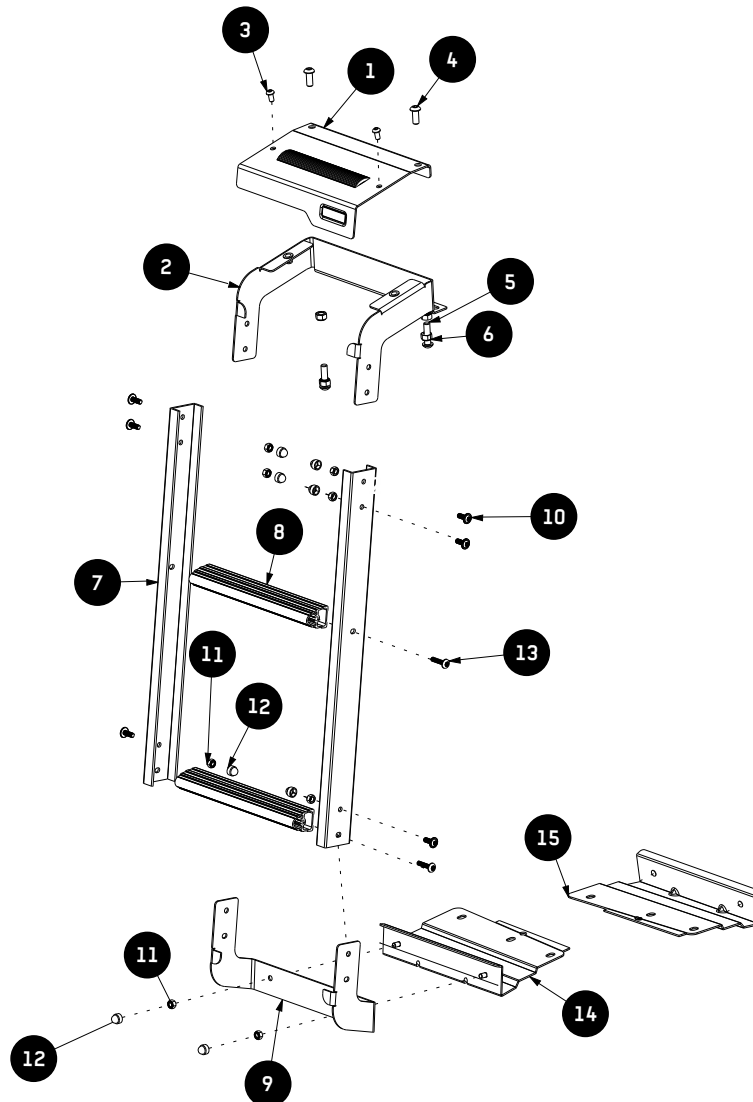
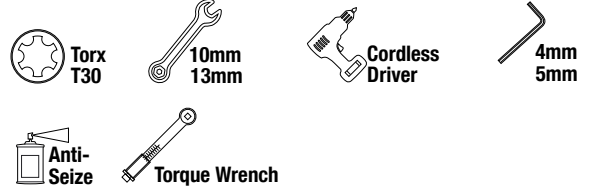

2.1

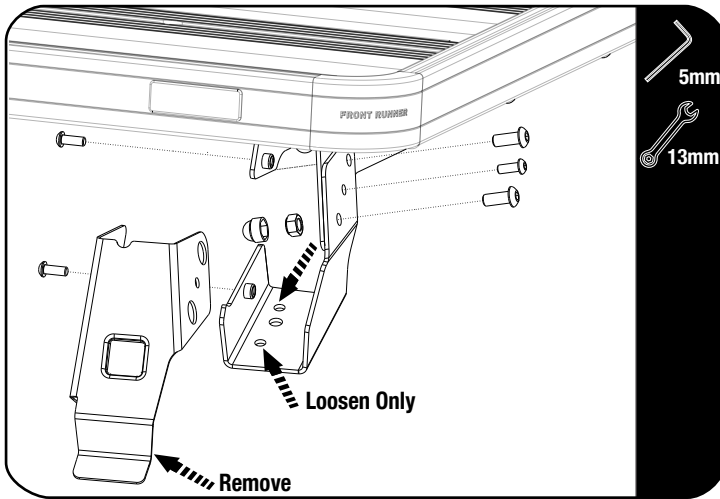

Loosen and remove the two front covers of the foot rails to access the four M6 nuts securing the foot rails to the windscreen accessory points.

**DO NOT REMOVE**

Loosen all the roof panel latches and remove the two front roof panels.

Slide the one piece mid panel forward to allow access to the two screws securing the rear roof to the rollbar. Loosen and remove these screws.

2.2



Remove the four screws on the inside rear ledges (2 per side) **DO NOT LOOSEN** the four smaller screws (2 per side) these are guide pins to re align the roof for fitment.

2.3



With the help of a friend lift the rear roof slightly to allow the ladder lower bracket to slip in between the roof ledge and the body panel.



**NOTE:** Be sure to use the correct lower bracket for the installation side chosen.

Align the holes in the plate with the holes in the roof ledge refit the two screws removed in step 2.2. **DO NOT FULLY TIGHTEN.**

Lower the roof back in position align and refit all the screws removed earlier and fully tighten.

2

FIT AND SECURE

2.4

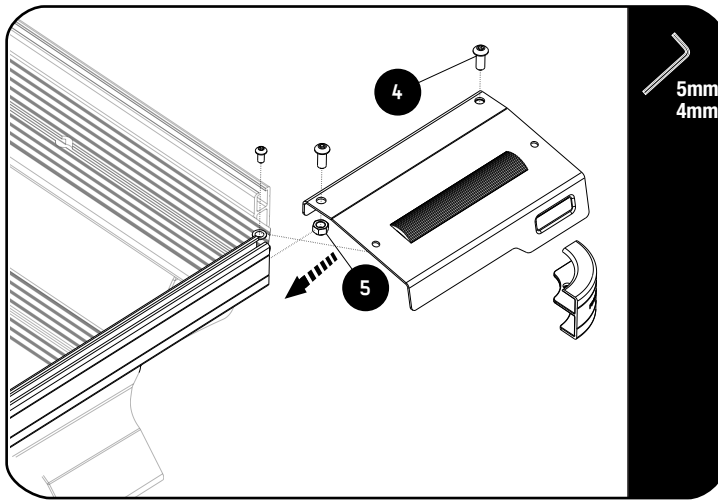

Fit the M8x20 Button Head Screws (Item 4) to the top step cover and thread the M8 Nylocs (Item 5) onto the M8x20 Button Head Screws.

Remove the rear SLII rack corner and slide the assembled top step cover into the side profile T slot as shown.

2.5

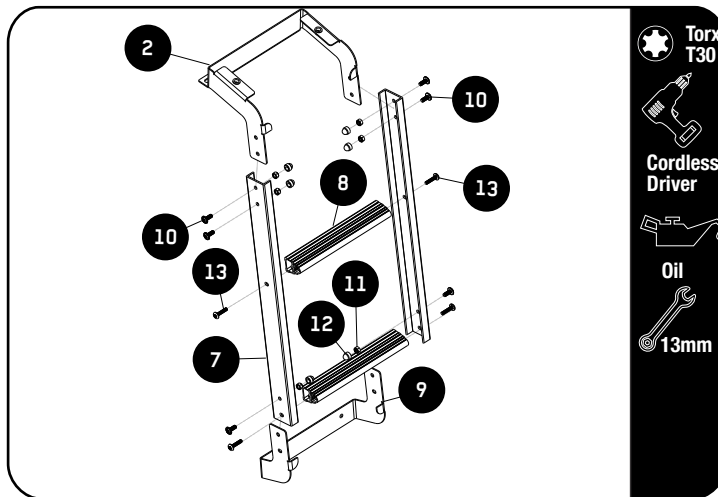

Assemble the Ladder Rung steps (Item 8) to the Ladder sides (Item 7) using the M6 x 25 Thread Forming Screws (Item 13).



Apply a little anti seize on screw threads before inserting. Note these are thread forming screws.

Fit the Top and Bottom mounting Brackets (Item 2 & 9) to the ladder using the M6 x 16 Button Head Screws and M6 Nyloc Nuts (Item 10 & 11).

Fully tighten all the fasteners inserted and place the M6 Nut Caps (Item 12) where needed.



**Tightening Torque:**

M8 : 15-20Nm / 11.06 ft lb - 14.75 ft lb

2.6

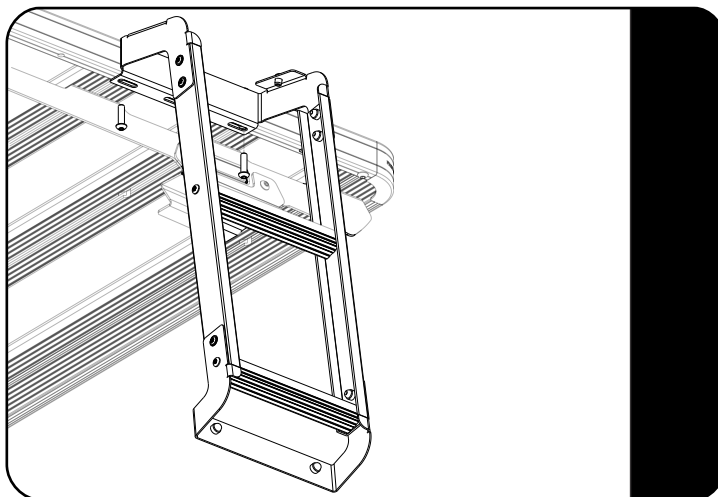

Remove the M8 x 30 Button Head screws from the 2nd and 3rd rear slats, position the assembled ladder onto the side profile and insert the supplied BHM8x30 screws (Item 5) into the 2nd and 3rd slat holes. DO NOT FULLY TIGHTEN.



2

FIT AND SECURE

2.7

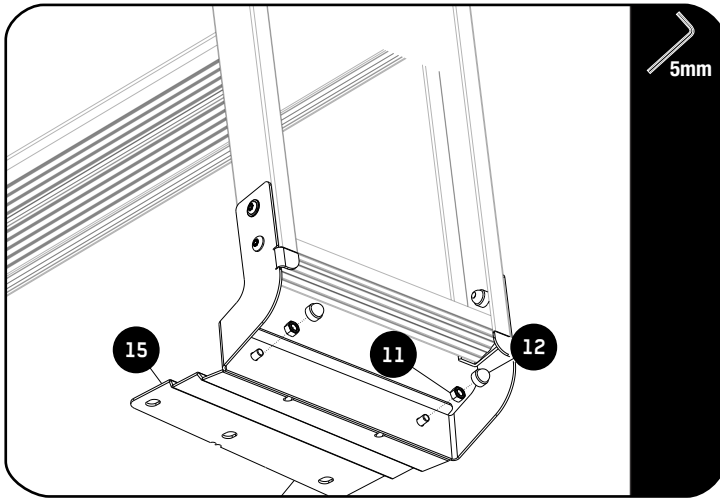

Align the ladder with the Bottom Bracket (Item 15) and thread the M6 Nyloc nuts (Item 11) onto the bottom bracket inserts.

Ensure the ladder is vertical and fully tighten the slat bolts inserted in 2.6.



**Tightening Torque:**

M6 : 8-10Nm / 5.9 ft lb - 7.38 ft lb

2.8

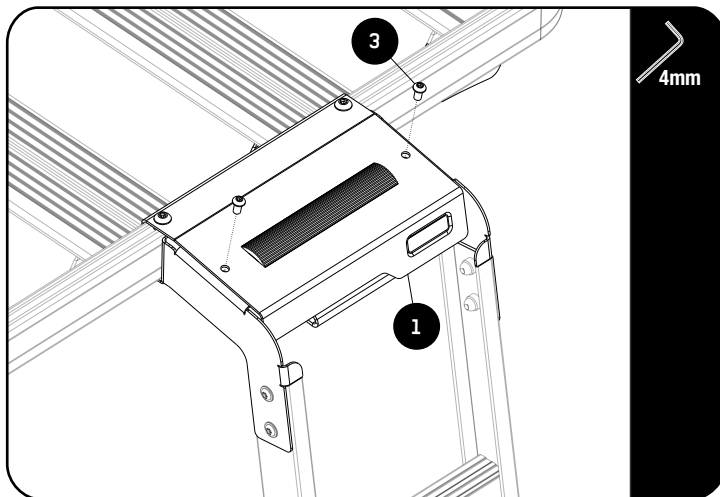

Fit the Top Step Cover (Item 1) and secure using the M6x12 button Head screws (Item 3) fully tighten.

Fully tighten the top two BHM8x20 in the side profile T slot that was inserted in 2.4.



**Tightening Torque:**

M6 : 8-10Nm / 5.9 ft lb - 7.38 ft lb

2.9

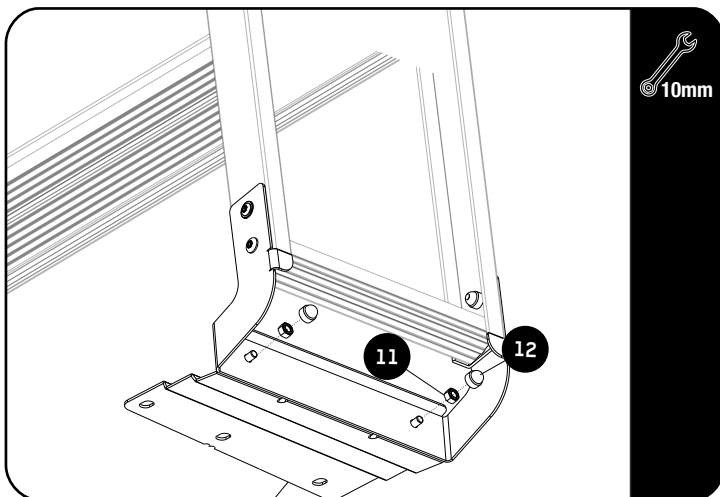

Fully tighten the two bottom M6 Nyloc nuts fitted in 2.7 and place the M6 Nut Caps (Item 12) over the nuts

Refit the Slimline II Rear Corner that was removed in 2.4.



**Tightening Torque:**

M6 : 8-10Nm / 5.9 ft lb - 7.38 ft lb

2

**FIT AND SECURE**

2.10

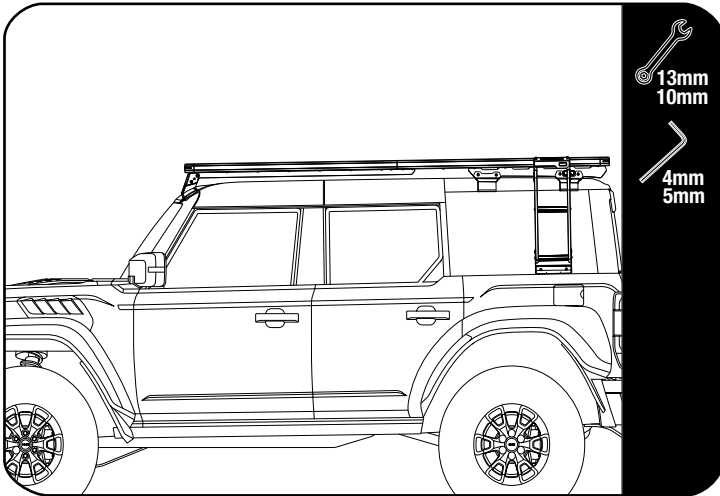

 Fully tighten the four nuts on the windscreen accessory points (2 per side) that was loosened in 2.1 and refit the Front covers.



**Tightening Torque:**

**M6 : 8-10Nm / 5.9 ft lb - 7.38 ft lb**



**Tightening Torque:**

**M8 : 15-20Nm / 11.06 ft lb - 14.75 ft lb**

3

**COMPLETION**

3.1

Congratulations! You did it. Take a step back and admire your work!



4

**INSTALL OTHER VEHICLE AND RACK ACCESSORIES**

Now's the time to visit your favorite Front Runner dealer in person or online.

**IMPORTANT!** 

FRONT RUNNER RACK KITS OFTEN HAVE A HIGHER LOAD RATING THAN THE VEHICLES THEY ARE MOUNTED TO. PLEASE REFER TO YOUR SPECIFIC VEHICLE MANUFACTURER FOR A RECOMMENDED ROOF RATING. FRONT RUNNER CANNOT BE RESPONSIBLE FOR IMPROPER LOADING BEYOND THE VEHICLE MANUFACTURER'S STATED LOAD CAPACITY.

Be sure to tag us. We love to see our gear in action! #FrontRunnerOutfitters #BornToRoam

Share your adventures on:

