**READ ME !** ⚠

Thank you for purchasing a Front Runner Toyota Rav4 Ladder.

Before you start, take a moment to familiarize yourself with the Fitting Instructions and the included components.

Refer to Page 2 for a list of all the components, quantities and tools required.

IMPORTANT WARNING! ⚠

IT IS CRITICAL THAT ALL FRONT RUNNER PRODUCTS BE PROPERLY AND SECURELY ASSEMBLED AND ATTACHED TO YOUR VEHICLE. IMPROPER ATTACHMENT COULD RESULT IN AN AUTOMOBILE ACCIDENT, AND COULD CAUSE SERIOUS BODILY INJURY OR DEATH. YOU ARE RESPONSIBLE FOR ASSEMBLING AND SECURING ALL FRONT RUNNER PRODUCTS TO YOUR VEHICLE, CHECKING THE ATTACHMENTS PRIOR TO USE, AND PERIODICALLY INSPECTING THE PRODUCTS FOR ADJUSTMENT, WEAR AND DAMAGE. THEREFORE, YOU MUST READ AND UNDERSTAND ALL OF THE INSTRUCTIONS AND PRECAUTIONS SUPPLIED WITH YOUR FRONT RUNNER PRODUCT PRIOR TO INSTALLATION OR USE. IF YOU DO NOT UNDERSTAND ALL OF THE INSTRUCTIONS AND CAUTIONS, OR IF YOU HAVE NO MECHANICAL EXPERIENCE AND ARE NOT THOROUGHLY FAMILIAR WITH THE INSTALLATION PROCEDURES, YOU SHOULD HAVE THE PRODUCT INSTALLED BY A PROFESSIONAL INSTALLER OR OTHER QUALIFIED PERSONNEL.

NOTE: Front Runner will not be responsible for any damage caused by the failure to install the product according to these instructions.

Please call us if you have any questions about the installation of this product.



1 GET ORGANIZED

IN THE BOX

1	1 X	Ladder Top Step Bracket
2	4 X	Ladder Side Profile
3	2 X	Side Joiner Outer Plate
4	2 X	Side Joiner Inner Plate
5	1 X	Bottom Step
6	2 X	Ladder Rung
7	1 X	Hinge Bracket
8	1 X	M6 x 40 Button Head Bolt
9	2 X	M6 x 25 Button Head Bolt
10	2 X	Aluminium Spacer
11	1 X	Bottom Mount Bracket
12	4 X	M6 x 19 x 1 Flat Washer
13	22 X	M6 Nyloc Nut
14	18 X	M6 Nut Cap
15	1 X	M6 Hex Nut
16	4 X	M6 x 16 Button Head Bolt
17	4 X	M6 x 20 x 2 Flat Washer
18	4 X	M6 x 25 Thread Forming Screw

IN THE BOX

19	16 X	M6 x 16 Flange Button Head Bolt
20	2 X	M5 Spring Washer
21	2 X	M5 x 10 Button Head Bolt
22	1 X	U-Channel Rubber (170mm Long)
23	1 X	Clear Vinyl Strip

TOOLS NEEDED

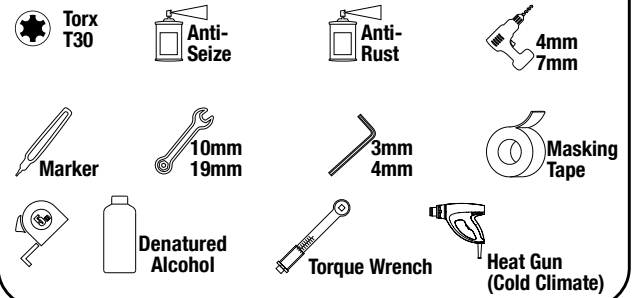
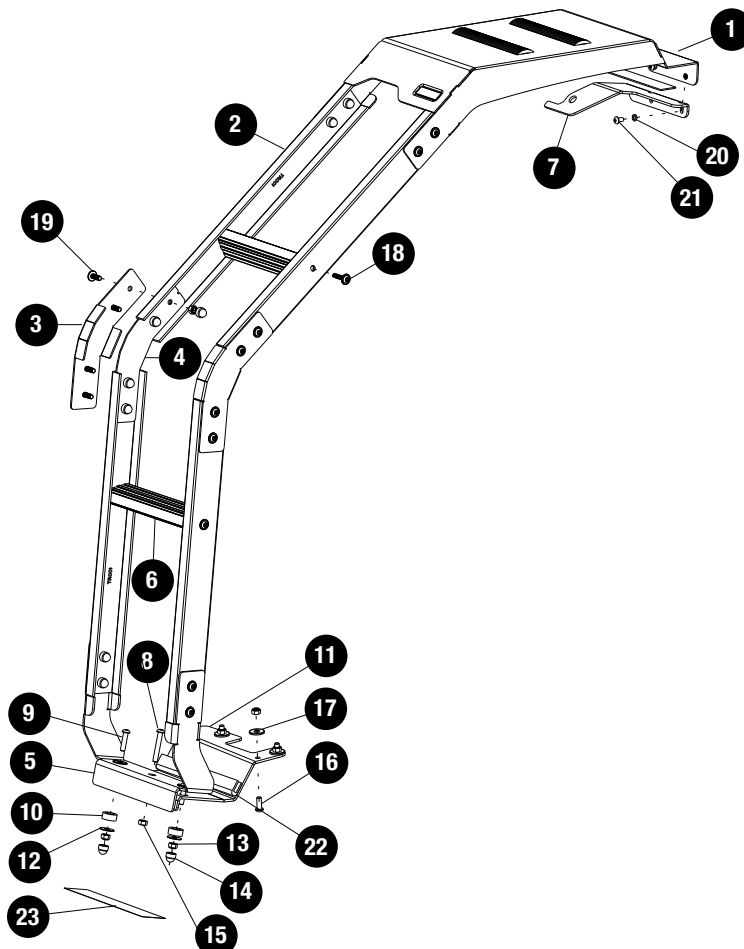

FIGURE 1.1



2

FIT AND SECURE

2.1

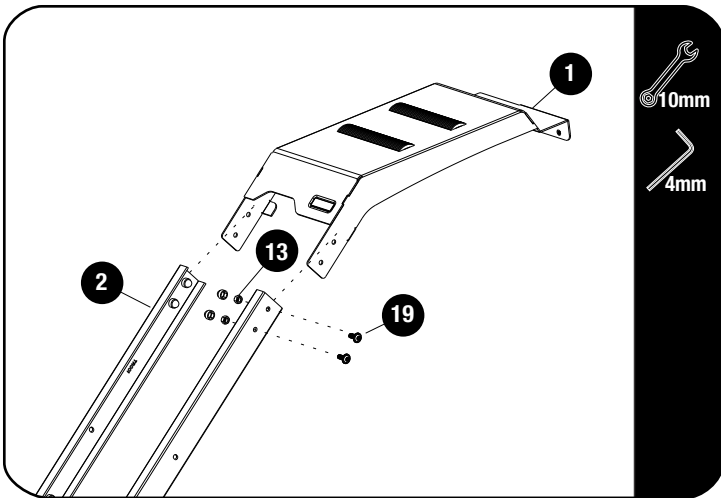

Loosely assemble two Ladder Side Profiles (Item 2) to the Ladder Top Step Bracket (Item 1) using the M6 x 16 Flange Button Head Bolts and M6 Nyloc Nuts (Items 19 & 13).



Note Side profile orientation. The ladder rungs are closer to the middle of the ladder.

Top Side Profiles: Distance from Rung to Top of Side Profile is longer.

Bottom Side Profiles: Distance from Rung to Bottom of Side Profile is longer.

2.2

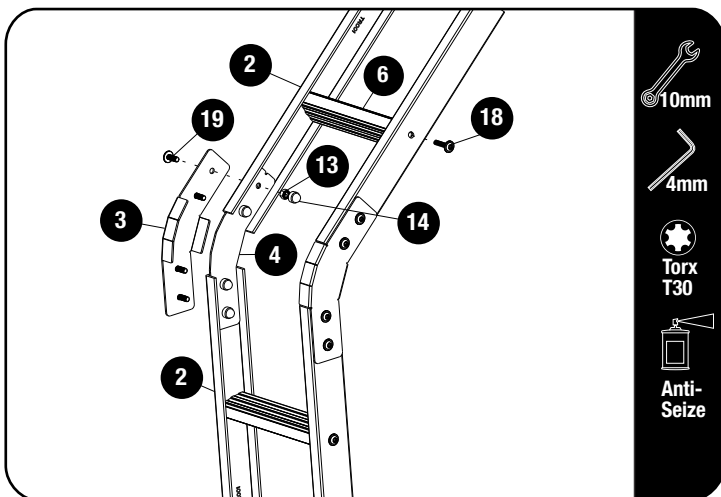

Apply a little Anti Seize / oil on Thread Forming Screws before inserting. Note these are thread forming screws.



Secure the Ladder Rungs (Item 6) to the Ladder Side Profiles (Item 2) using M6 x 25 Thread Forming Screws (Item 18). Join Side Profiles with Side Joiner Outer Plate and Side Joiner Inner Plate (Items 3 & 4) using M6 x 16 Flange Button Head Bolts and M6 Nyloc Nuts (Items 19 & 13). Fully Tighten all Fasteners.



Tightening Torque 8-10Nm / 5.9 ft lb - 7.38 ft lb. Take care when using a cordless driver.

Place M6 Nut Caps (Item 14) over all Nyloc Nuts.

2.3

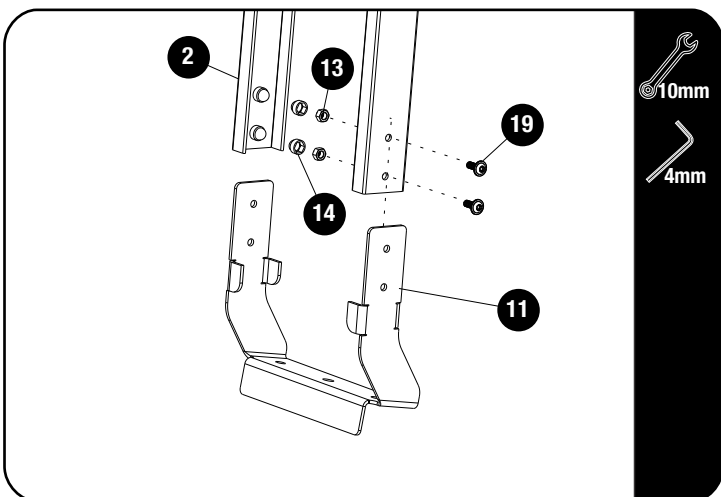

Secure the Bottom Mount Bracket to the Ladder Side Profiles (Items 11 and 2) using M6 x 16 Flange Button Head Bolts and M6 Nyloc Nuts (Items 19 & 13). Fully Tighten all Fasteners.

Place M6 Nut Caps (Item 14) over all Nyloc Nuts.

2.4



Loosen and remove the Right Hand OEM Bolt on the Left Hand side Hinge on the inside of the tailgate. Attach the Hinge Bracket (Item 7) to act as a guide for the placement of the ladder.

2.5

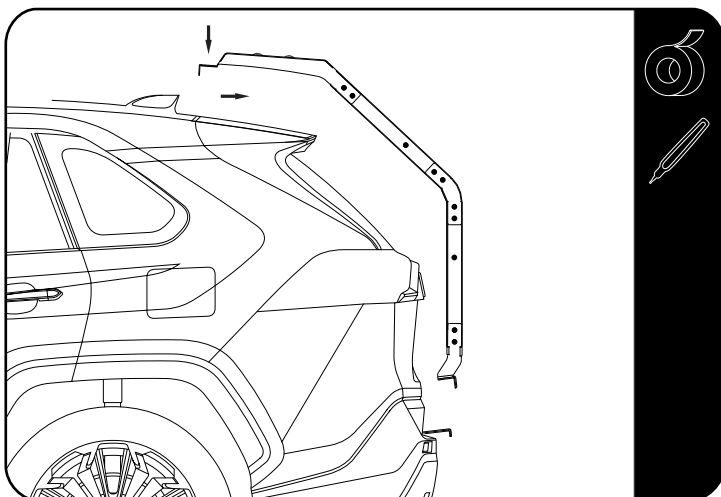

Align the Ladder with the Hinge Bracket and mark the top position with Masking Tape and a marking pen.

Making sure it is level, mark the Bottom position of the ladder with masking tape. Remove the Ladder assembly.

2.6

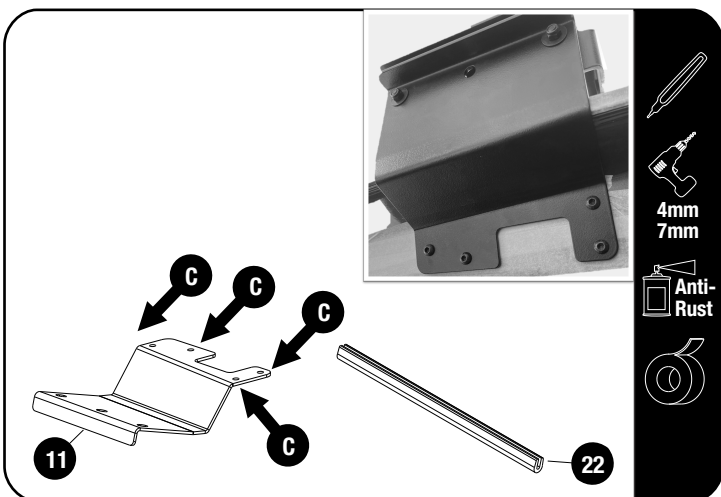

Open the Tail Gate and remove the plastic Liner to reveal the metalwork.

Place the U-Channel Rubber (Item 22) over the door edge where the Bottom Mount Bracket (Item 11) will be secured.

Align the Bottom Mount Bracket (Item 11) with the markings made in Step 2.5. Lay down some Masking Tape.

Mark the hole centers (C) as shown. Drill a 4mm Pilot hole and open up to 7mm.

Apply Anti-Rust on drilled holes.

2.7

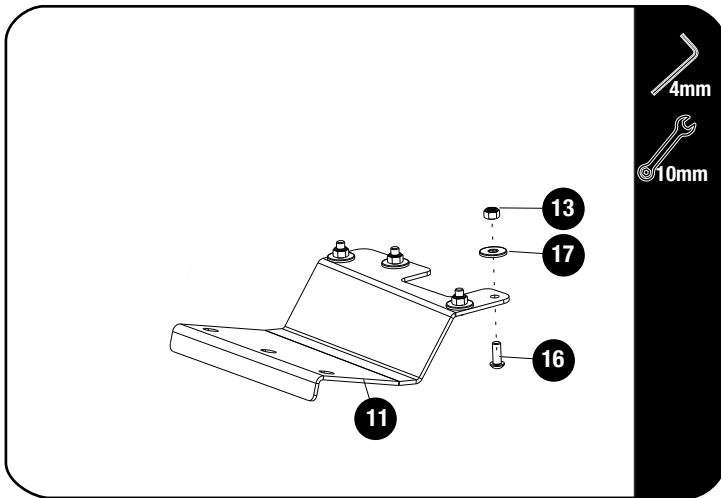

Secure the Bottom Mount Bracket (Item 11) to the Tail Gate with M6 x 16 Button Head Bolts, M6 x 20 x 2 Flat Washers and M6 Nyloc Nuts (Items 16, 17 & 13)

2.8

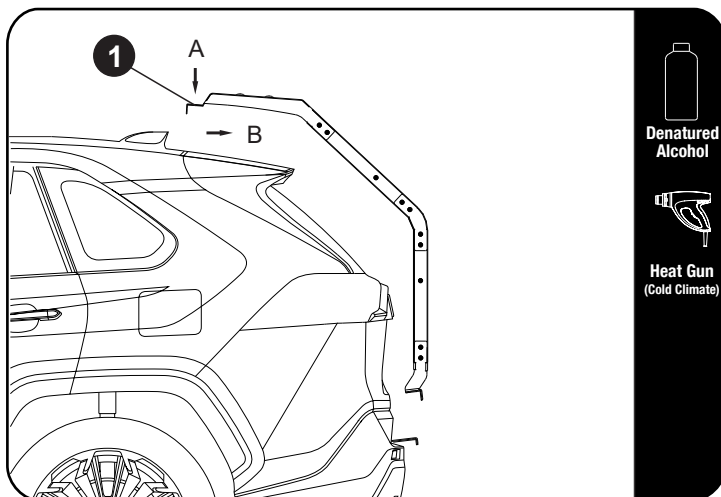

Clean the hatch top surface thoroughly with alcohol.

Remove the backing of the VHB tape (Item 1).

Slowly slide the ladder Top Bracket into the hatch gap (A) while pulling it backward (B) at the same time, insuring it is against the hatch edge.

Take care not to let the VHB Tape touch the surface yet.

Align the Top Bracket edge with the mark made earlier before firmly pressing the Top Bracket onto the hatch top.



Note: With the backing removed, heat up the self-adhesive tape with a heat gun before fixing it in place. This is especially important in colder climates.

2.9

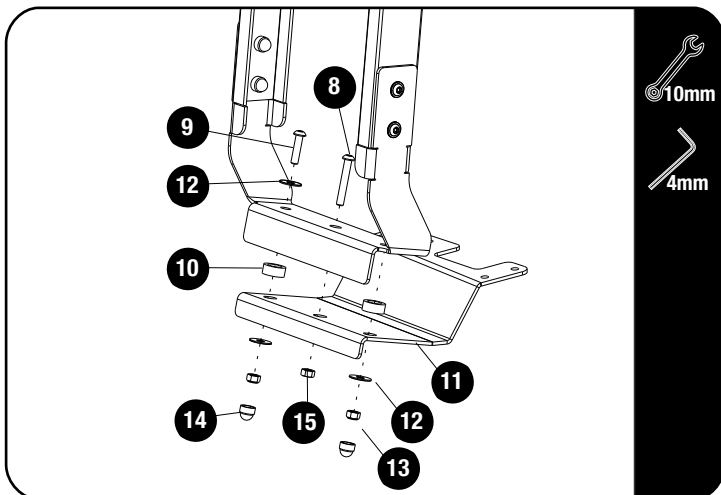

Secure the Ladder assembly to the Bottom Mount Bracket (Item 11) as shown.

Use the M6 x 40 Button Head Bolt and Standard Nut (Items 8 & 15) in the middle hole and start the clamping process, then use the M6 x 25 Button Head Bolts, M6 x 19 x 1 Flat Washers, M6 Nyloc Nuts and Aluminium Spacers (Items 9, 12, 13 & 10) in the other two holes. Remove the M6 x 40 Button Head Bolt and standard Nut.

Place M6 Nut Caps (Item 14) over M6 Nyloc Nuts (Item 13).

2

FIT AND SECURE

2.10

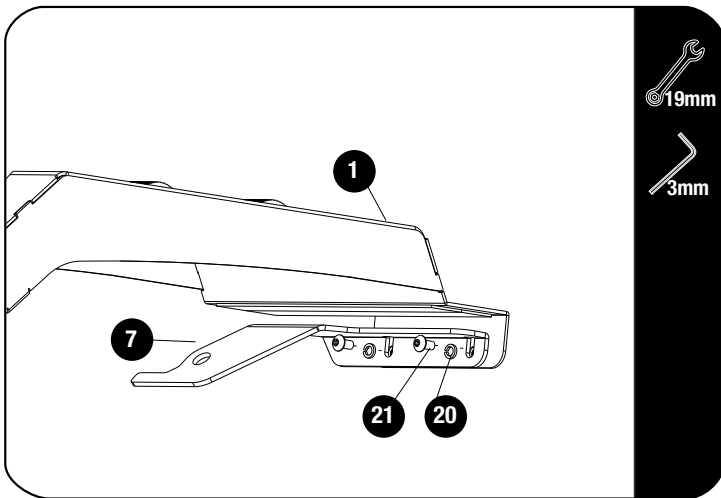

Secure the Top Step Bracket (Item 1) to the Hinge Bracket (Item 7) using M5 x 10 Button Head Bolts and M5 Spring Washers (Items 20 & 21)

Tighten all Fasteners.

3

FINISH

Congratulations! You did it. Take a step back and admire your work!

4

INSTALL OTHER VEHICLE AND RACK ACCESSORIES

Now's the time to visit your favorite Front Runner Dealer in person or online.

Be sure to tag us. We love to see our gear in action! #FrontRunnerOutfitters #BornToRoam

Share your adventures on: 