



FRONT RUNNER
VEHICLE OUTFITTERS

SUMP & GEARBOX GUARD
MITSUBISHI PAJERO SPORT (QE SERIES)

ENG

SGMP003

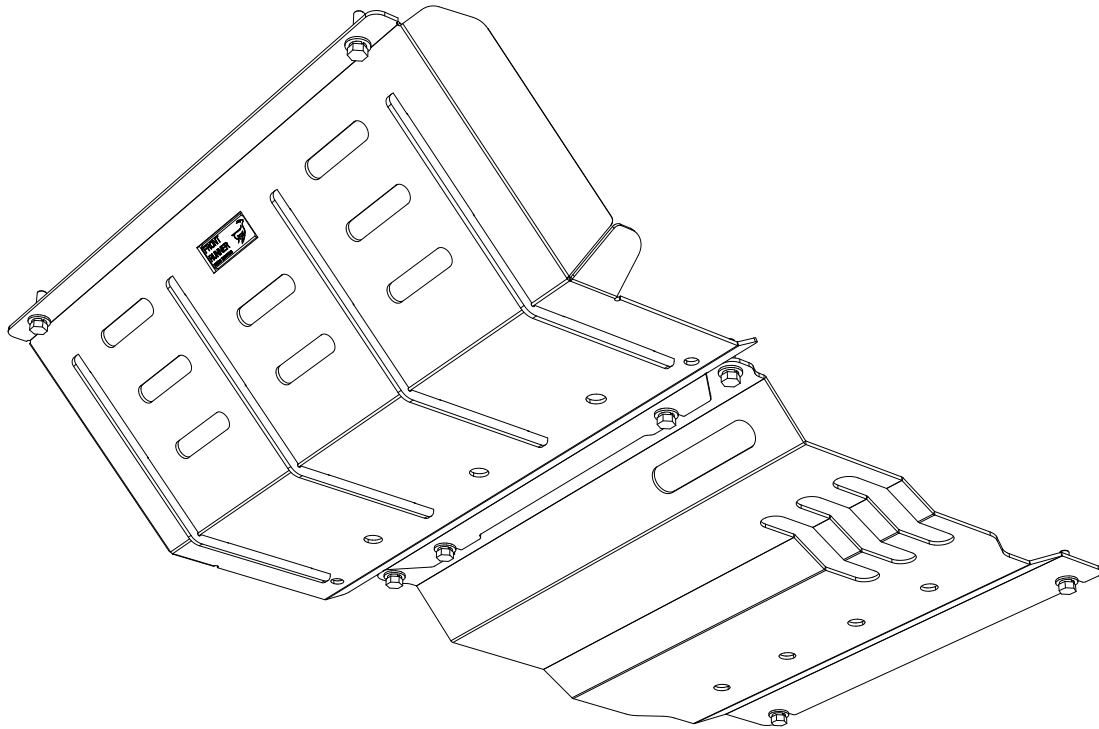

READ ME FIRST! ⚠

Thank you for purchasing a Front Runner Mitsubishi Pajero Sport (QE Series) Sump and Gearbox Guard.
Before you start, take a moment to familiarize yourself with this Fitting Instruction and the components received.
Refer to Page 2 for a list of all the components, quantities and tools required.

IMPORTANT WARNING! ⚠

IT IS CRITICAL THAT ALL FRONT RUNNER PRODUCTS BE PROPERLY AND SECURELY ASSEMBLED AND ATTACHED TO YOUR VEHICLE. IMPROPER ATTACHMENT COULD RESULT IN AN AUTOMOBILE ACCIDENT, AND COULD CAUSE SERIOUS BODILY INJURY OR DEATH. YOU ARE RESPONSIBLE FOR ASSEMBLING AND SECURING ALL FRONT RUNNER PRODUCTS TO YOUR VEHICLE. CHECKING THE ATTACHMENTS PRIOR TO USE, AND PERIODICALLY INSPECTING THE PRODUCTS FOR ADJUSTMENT, WEAR AND DAMAGE. THEREFORE YOU MUST READ AND UNDERSTAND ALL OF THE INSTRUCTIONS AND PRECAUTIONS SUPPLIED WITH YOUR FRONT RUNNER PRODUCT PRIOR TO INSTALLATION OR USE. IF YOU DO NOT UNDERSTAND ALL OF THE INSTRUCTIONS AND CAUTIONS, OR IF YOU HAVE NO MECHANICAL EXPERIENCE AND ARE NOT THOROUGHLY FAMILIAR WITH THE INSTALLATION PROCEDURES, YOU SHOULD HAVE THE PRODUCT INSTALLED BY A PROFESSIONAL INSTALLER OR OTHER QUALIFIED PERSONNEL.

1

GET ORGANIZED

Here is what you are looking at for SGMP003

IN THE BOX

1	1 X	Sump Guard
2	1 X	Gearbox Guard
3	8 X	M8x19x2SS Flat Washer
4	8 X	M8 Spring Washer
5	6 X	M8x30 Hex Bolt
6	2 X	M8x25 Hex Bolt

TOOLS NEEDED



FIGURE 1.1

REAR OF VEHICLE

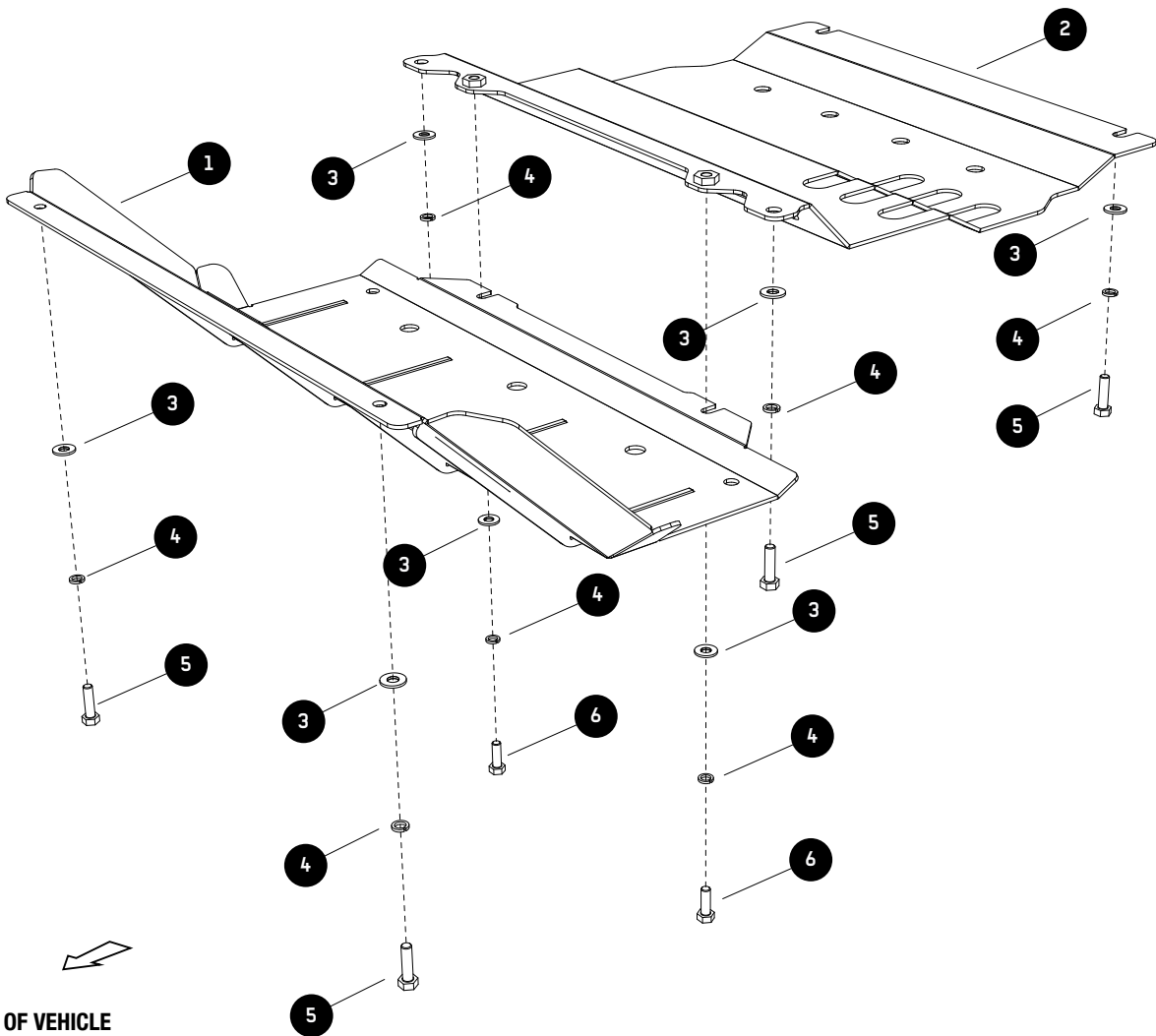

FRONT OF VEHICLE

2

PREPERATION

2.1

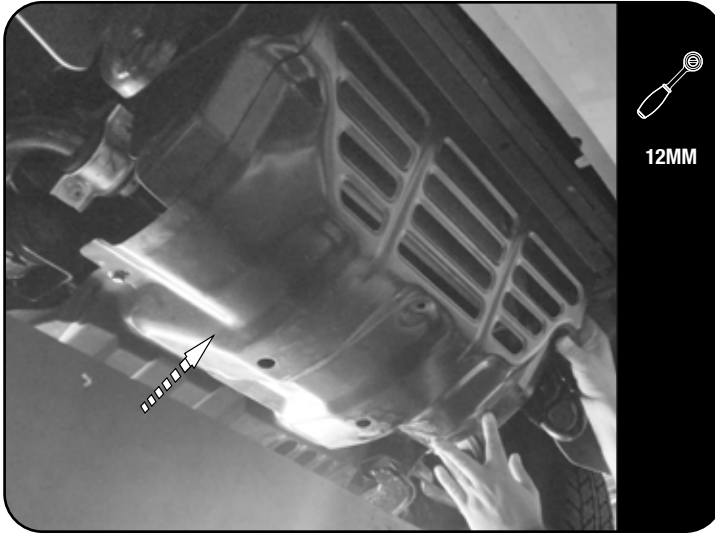

Before you start to fit your Front Runner Sump and Gearbox Guards, you need to loosen and remove the existing sump guard.

2.2

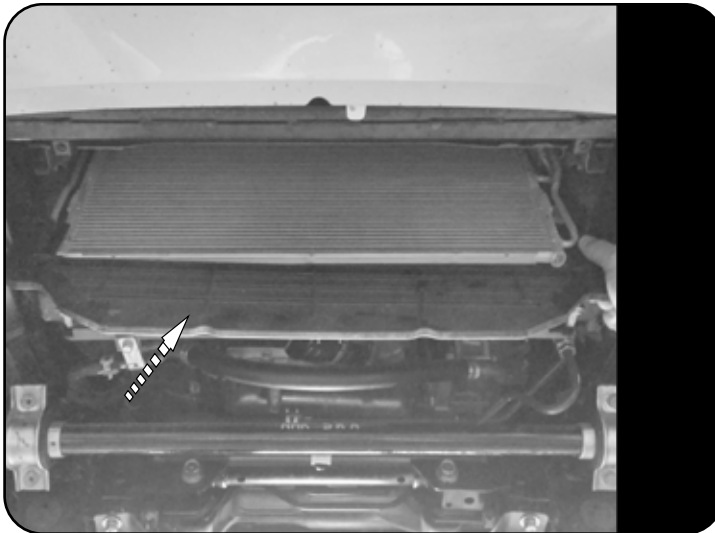

After removing the sump guard you will find a plastic component. This has to be un-clipped and removed.

2.3

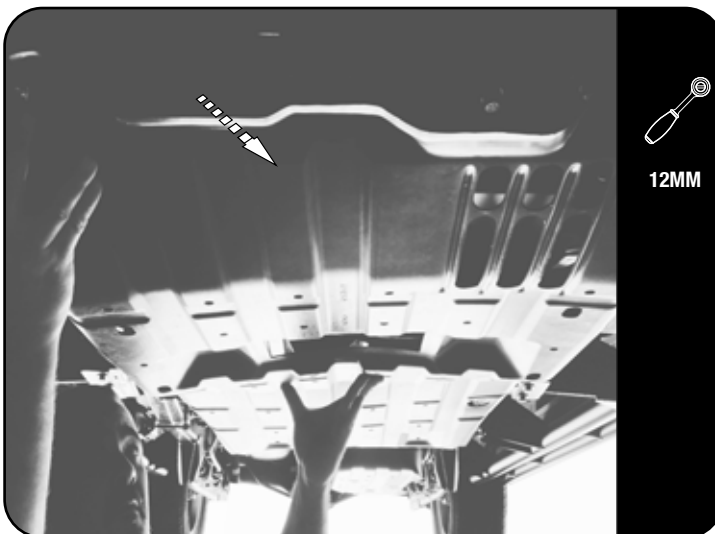

The original gearbox guard needs to be removed before you can fit your Front Runner Sump and Gearbox Guard.

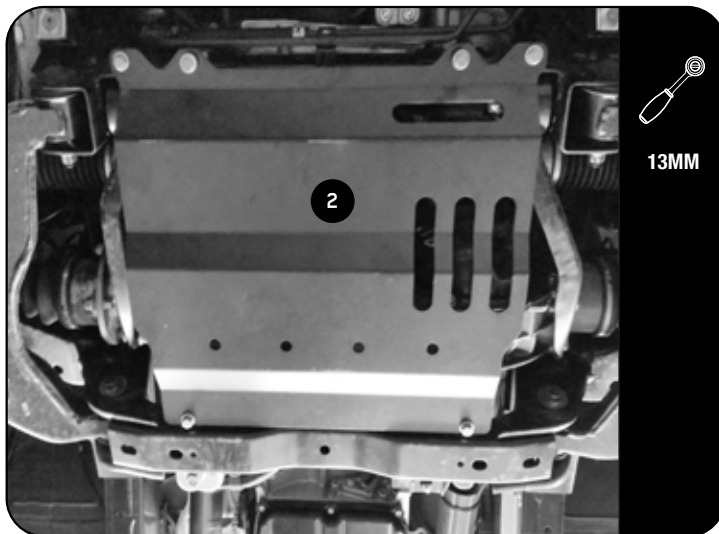
3**FIT AND SECURE****3.1**

 Start by placing the Gearbox Guard (Item 2) over the existing holes in the chassis. Use the fasteners shown in figure 1.1 and loosely fit in place.

3.2

 Now place the Sump Guard (Item 1) over the holes in the Gearbox Guard and the front holes on the chassis. Use the fasteners shown in figure 1.1 to secure.

After all the fasteners has been inserted you can fully tighten the Sump and Gear Guard in place.

Tightening Torque 40Nm

4 COMPLETION

4.1



Congratulations. You did it. Take a step back and admire your work!

5 INSTALL OTHER VEHICLE AND RACK ACCESSORIES

Now's the time to visit your favorite Front Runner Dealer in person or online.