



FRONT RUNNER
VEHICLE OUTFITTERS

TRACKS _ 3082MM-4098MM(L)
MERCEDES SPRINTER (2013-CURRENT)

ENG

TRMS001

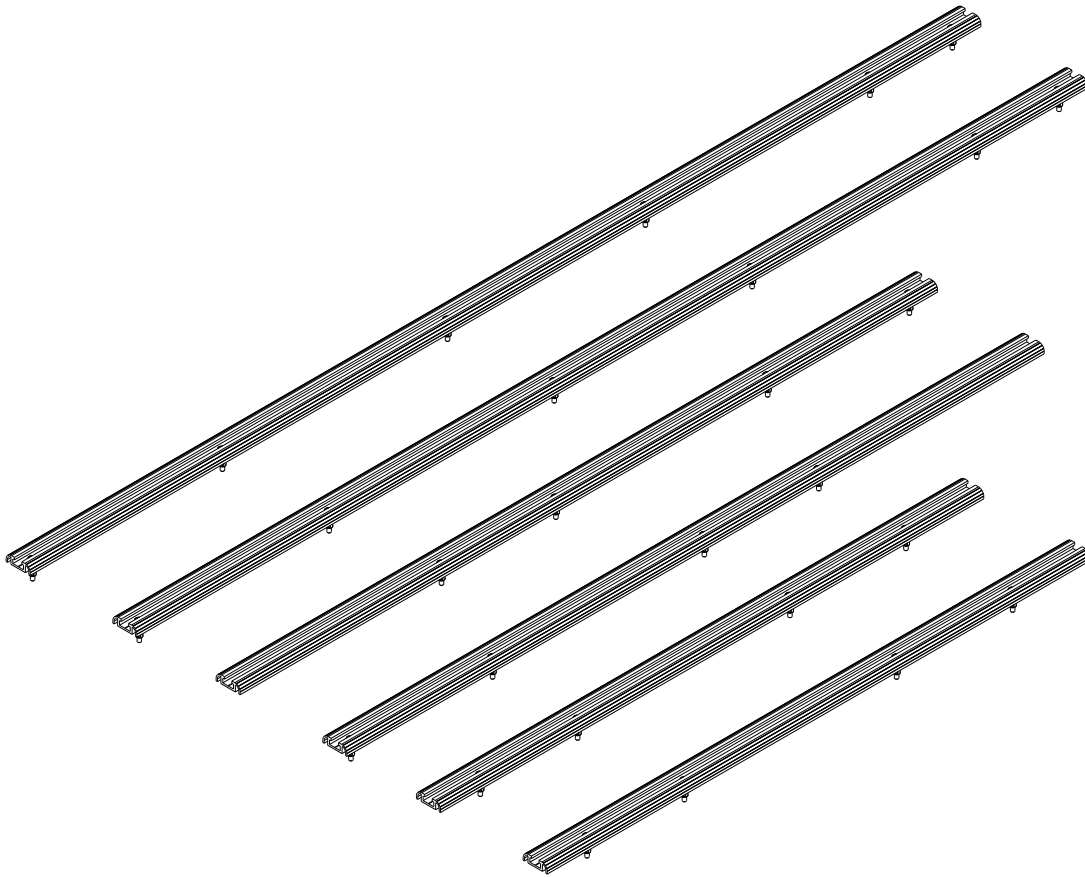

READ ME !

Thank you for purchasing Front Runner Mount Mercedes Sprinter Tracks.

Before you start, take a moment to familiarize yourself with the Fitting Instructions and the components received.

Refer to Page 2 for a list of all the components, quantities and tools required.

NOTE: Front Runner will not be responsible for any damage caused by the failure to install the product according to these instructions. Please call us if you have any questions about the installation of this product.

IMPORTANT WARNING!

FRONT RUNNER CAN NOT RECOMMEND A MAXIMUM LOAD CARRYING CAPACITY. PLEASE REFER TO YOUR VEHICLE MANUFACTURER'S RECOMMENDATIONS. IT IS CRITICAL THAT ALL FRONT RUNNER PRODUCTS BE PROPERLY AND SECURELY ASSEMBLED AND ATTACHED TO YOUR VEHICLE. IMPROPER ATTACHMENT COULD RESULT IN AN AUTOMOBILE ACCIDENT, AND COULD CAUSE SERIOUS BODILY INJURY OR DEATH. YOU ARE RESPONSIBLE FOR ASSEMBLING AND SECURING ALL FRONT RUNNER PRODUCTS TO YOUR VEHICLE. CHECKING THE ATTACHMENTS PRIOR TO USE, AND PERIODICALLY INSPECTING THE PRODUCTS FOR ADJUSTMENT, WEAR AND DAMAGE. THEREFORE YOU MUST READ AND UNDERSTAND ALL OF THE INSTRUCTIONS AND PRECAUTIONS SUPPLIED WITH YOUR FRONT RUNNER PRODUCT PRIOR TO INSTALLATION OR USE. IF YOU DO NOT UNDERSTAND ALL OF THE INSTRUCTIONS AND CAUTIONS, OR IF YOU HAVE NO MECHANICAL EXPERIENCE AND ARE NOT THOROUGHLY FAMILIAR WITH THE INSTALLATION PROCEDURES, YOU SHOULD HAVE THE PRODUCT INSTALLED BY A PROFESSIONAL INSTALLER OR OTHER QUALIFIED PERSONNEL.

1

GET ORGANIZED

IN THE BOX

1	2 X	Track - 1016mm Long
2	2 X	Track - 1304mm Long
3	2 X	Track - 1778mm Long
4	28 X	M6 x 30 Countersink Screw
5	28 X	M6 Jack Nut
6	2 X	M6 x 30 Button Head Bolt
7	1 X	Installer Wrench

TOOLS NEEDED

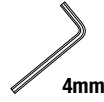

4mm Allen Key Bit

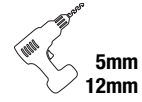

5mm
12mm



Sealant

FIGURE 1.1

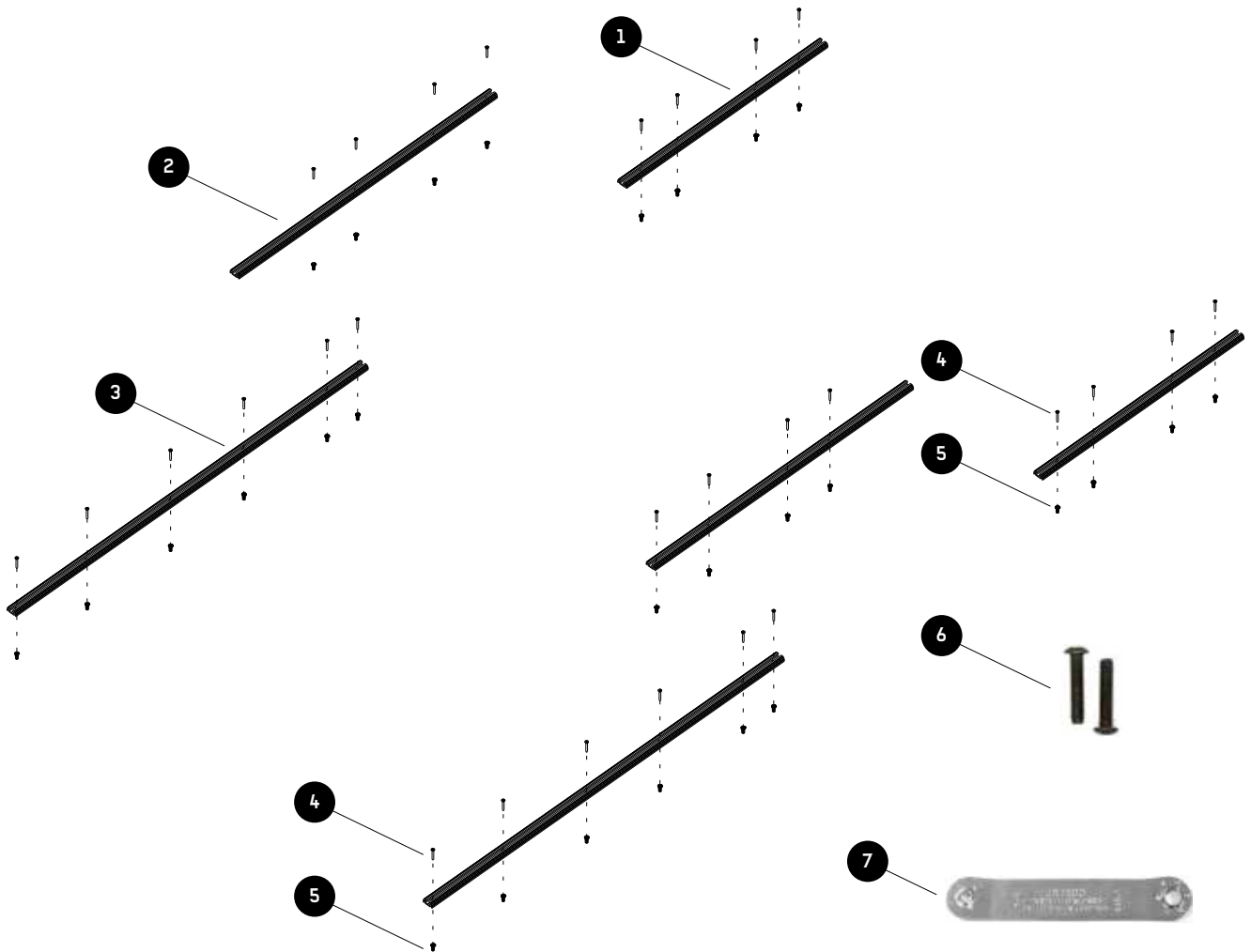

2

PREPARATION

2.1

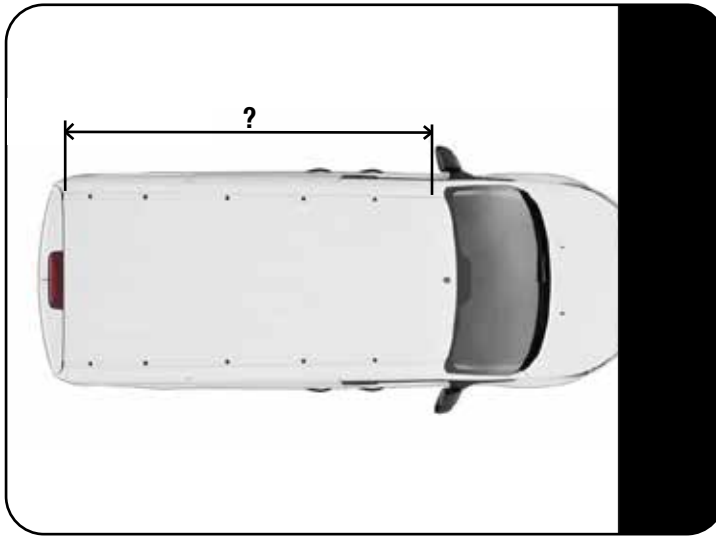

Depending on the length of your vehicle, you will use a combination of 2 to 3 tracks each side.

2.2

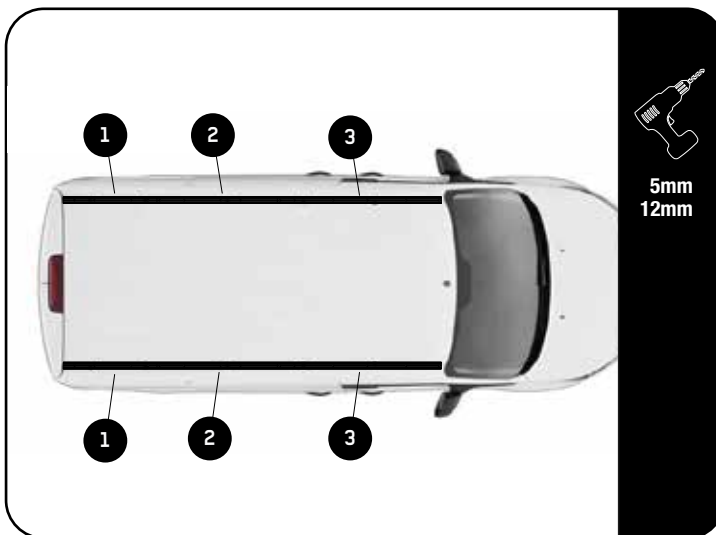

When placing the Tracks on the vehicle, make sure that the pre-drilled holes in the Tracks does not line up with the plastic inserts in the vehicles roof.

Mark all the holes in the Tracks onto the roof of the vehicle. Make sure that the tracks does not move when making.

Remove the Tracks and drill a 4mm pilot hole. Open the to 12mm.

2.3

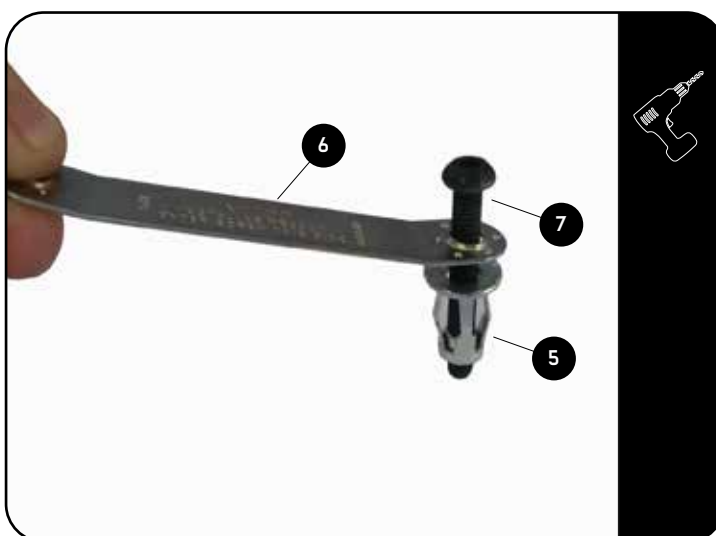

Using the Installer Wrench (Item 6) and a M6 x 30 Button Head Bolt (Item 7), insert the M6 Jack Nuts (Item 5).

Insert the M6 Button Head Bolt into the one side of the Installer Wrench. Loosely fit a Jack Nut to the Button Head Bolt as shown.

Place the assembly into the hole drilled in Step 2.2. Using a Drilling Machine and a 4mm Allen Key Bit secure the Jack Nut into the hole while holding onto the handle of the Installer Wrench.

Make sure that the Jack Nut has pulled up all the way to the inside skin of the roof panel.

2

PREPARATION

2.4

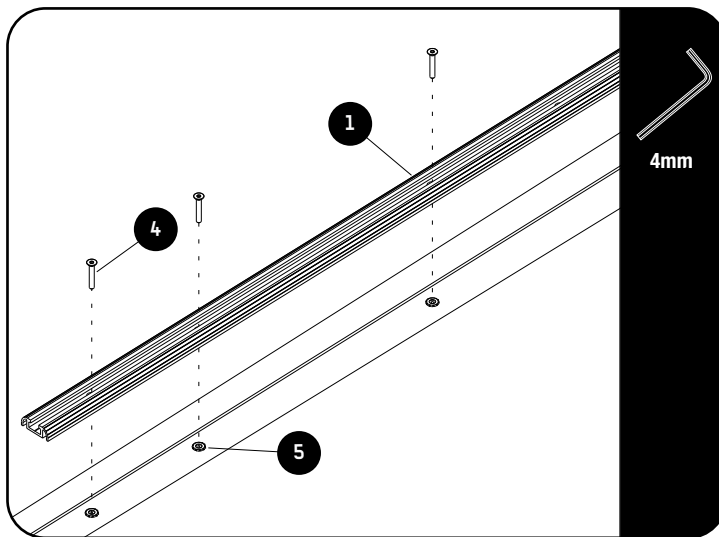

Place a bead of Silicon around each of the Jack Nut heads after securing them to the vehicle.

Place the Tracks in the same sequences as you placed in in Step 2.2.

Secure using M6 x 30 Countersunk Allen Cap Screws (Item 4) as shown.

3

COMPLETION

3.1



Congratulations! You did it. Take a step back and admire your work!

4

INSTALL OTHER VEHICLE AND RACK ACCESSORIES

Now's the time to visit your favorite Front Runner Dealer in person or Online.

Be sure to tag us. We love to see our gear in action! #FrontRunnerOutfitters #BornToRoam

Share your adventures on: 